



# VARIOUS LOCATIONS - FY24 SUMMER PAVING PROJECT - CONCRETE

## DRAWING INDEX

SHEET NO.	DESCRIPTION
1	COVER SHEET / PROJECT LOCATION
2	STANDARD NOTES
3-4	SIGN LOCATION AND TRAFFIC CONTROL
5-6	MICK DEEVER RD REPAIR PLAN
7-8	MICK DEEVER RD STRIPING PLAN
9	AUDRAIN CLINIC REPAIR PLAN
10	AUDRAIN CLINIC STRIPING PLAN
11	TARA APARTMENTS REPAIR PLAN
12	TYPICAL SECTIONS AND DETAILS

## UNIVERSITY OF MISSOURI

FOR THE CURATORS OF THE UNIVERSITY OF MISSOURI

PROJECT NO. CP241343

BID SET ISSUED: 03/25/2024

### SAFETY NOTICE TO CONTRACTOR

IN ACCORDANCE WITH GENERALLY ACCEPTED CONSTRUCTION PRACTICES, THE GENERAL CONTRACTOR SHALL BE SOLELY AND COMPLETELY RESPONSIBLE FOR CONDITIONS OF THE JOB SITE, INCLUDING SAFETY OF ALL PERSONS AND PROPERTY DURING PERFORMANCE OF THE WORK. THIS REQUIREMENT WILL APPLY CONTINUOUSLY AND NOT BE LIMITED TO NORMAL WORKING HOURS. ANY CONSTRUCTION OBSERVATION BY THE ENGINEER OF THE CONTRACTOR'S PERFORMANCE DOES NOT INCLUDE REVIEW OF THE ADEQUACY OF THE CONTRACTOR'S SAFETY MEASURES, IN, ON, OR NEAR THE CONSTRUCTION SITE.

### ENGINEER'S CERTIFICATION

I HEREBY CERTIFY THAT THESE PLANS WERE PREPARED BY ME OR UNDER MY DIRECT SUPERVISION AND THAT I AM A DULY REGISTERED PROFESSIONAL ENGINEER EXISTING UNDER THE LAWS OF THE STATE OF MISSOURI. I FURTHER CERTIFY THAT TO THE BEST OF MY KNOWLEDGE THESE DRAWINGS AND/OR SPECIFICATIONS ARE AS REQUIRED BY AND IN COMPLIANCE WITH THE BUILDING CODES OF THE UNIVERSITY OF MISSOURI.

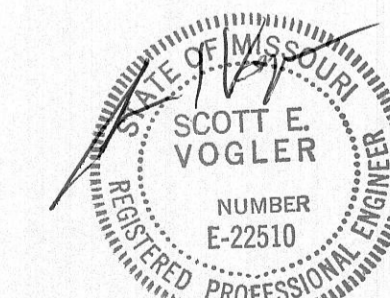

SCOTT E. VOGLER P.E. NO. E-22510

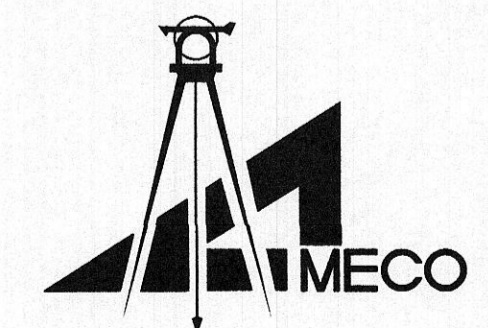

MECO ENGINEERING COMPANY INC.  
ENGINEERS \* SURVEYORS  
2701 INDUSTRIAL DRIVE  
JEFFERSON CITY, MISSOURI 65109  
(573) 893-5558

MECO PROJECT NO. 473-070

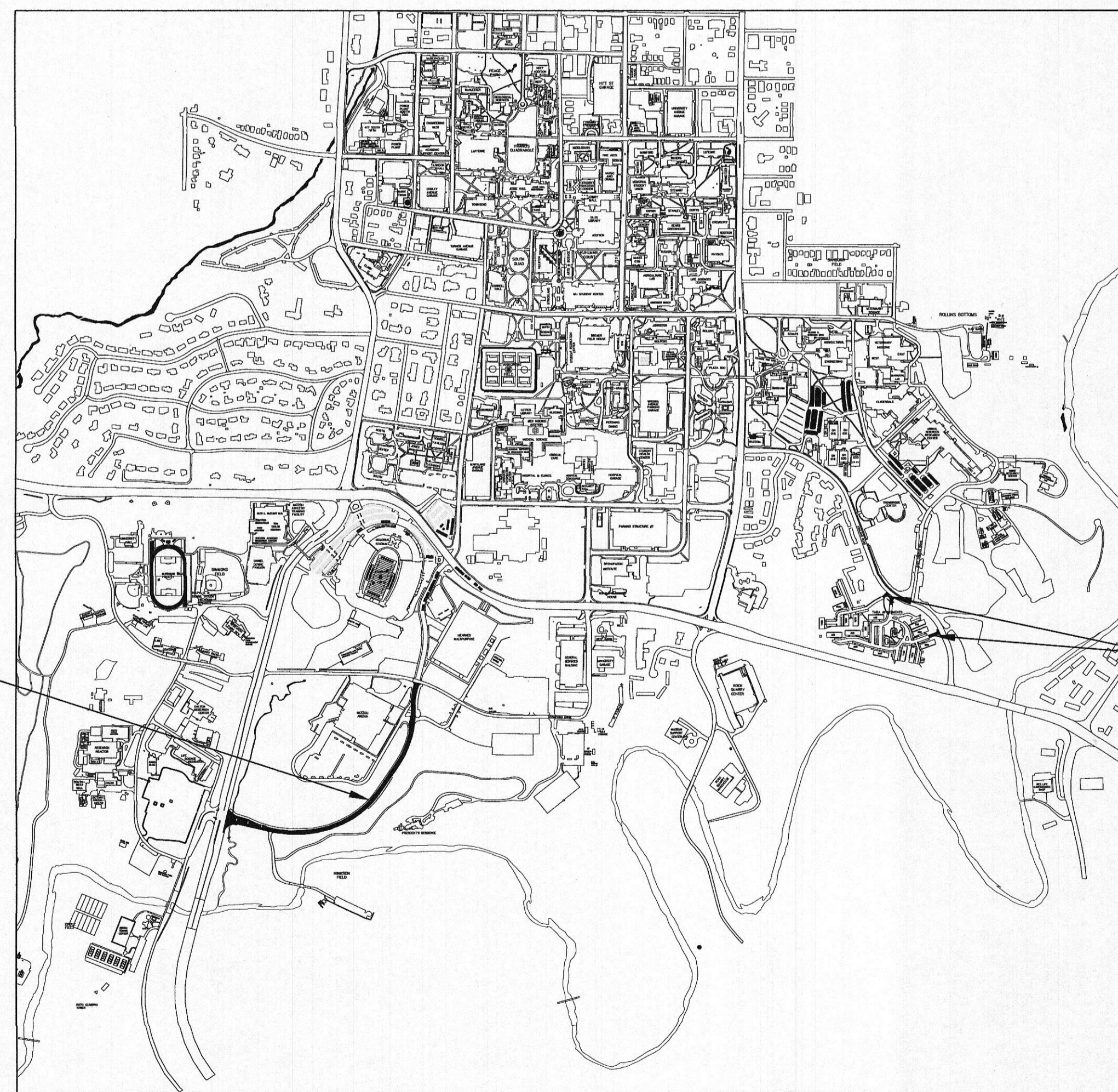

SITE LOCATION MAP

NO SCALE

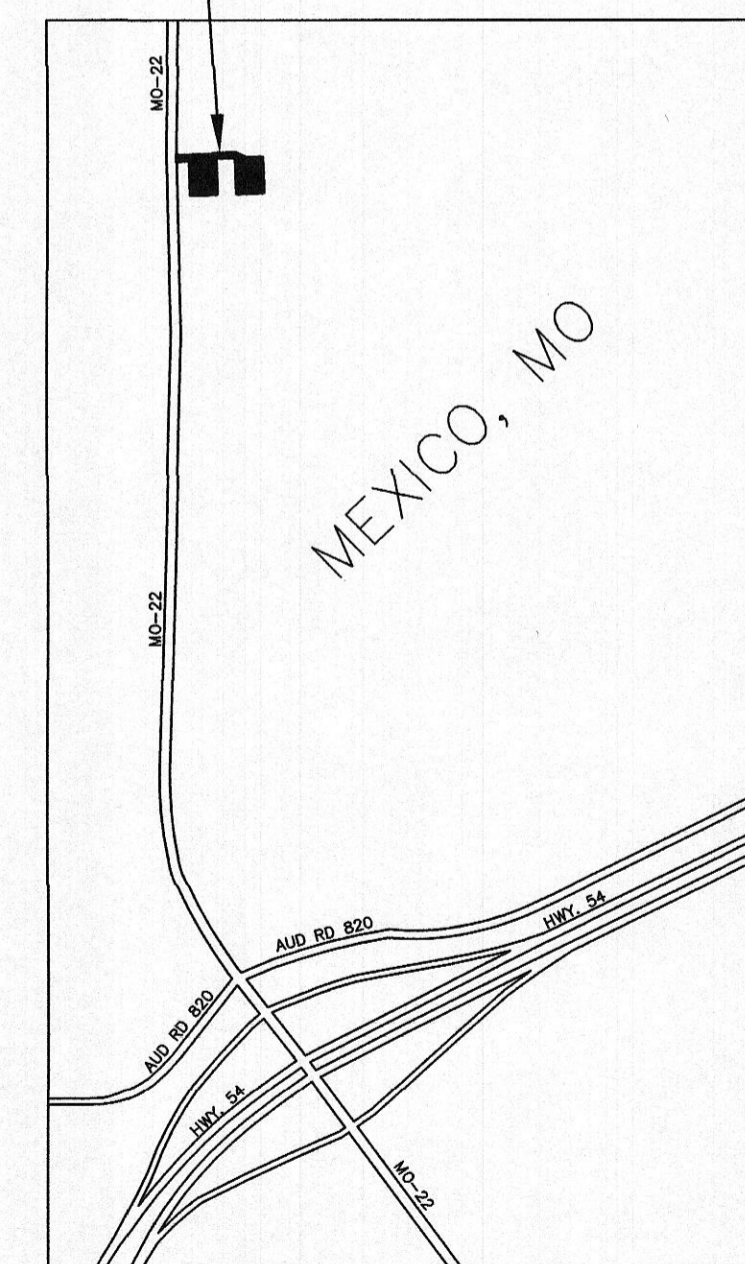

SITE LOCATION MAP

NO SCALE

L:\MO\Projects\473-070\1002\2024 Summer Paving - Design\DRAWINGS\CONCRETE\PACKAGE\001-C\_Ans\_Cover\_3/25/2024 7:31:09 AM

**UTILITY NOTES**

UTILITY CONTACTS ONE CALL FOR THE SITES IS GENERALLY THE UNIVERSITY. BELOW ARE ADDITIONAL CONTACTS FOR UTILITIES OWNED BY OTHER ENTITIES ON CITY OF COLUMBIA RIGHTS-OF-WAY. THE UNIVERSITY OPERATES STORM SEWERS, SANITARY SEWERS, ELECTRIC, TELECOMMUNICATIONS, STEAM, CHILLED WATER, POTABLE WATER, AND OTHER UTILITIES ON THE COLUMBIA CAMPUS.

MU ENERGY MANAGEMENT 573-882-3094  
 WATER  
 SANITARY SEWER  
 ELECTRIC

MISSOURI ONE-CALL SYSTEM 1-800-DIG-RITE  
 1-800-344-7483



GAS AMEREN/UE  
 210 ORR STREET  
 COLUMBIA, MISSOURI 65201  
 CONTACT: DON HARTLEY 573-876-3208

TELEVISION MEDIACOM  
 901 N. COLLEGE AVENUE  
 COLUMBIA, MISSOURI 65205  
 573-443-1535

TELEPHONE A T & T  
 400 WACO ROAD  
 COLUMBIA, MISSOURI 65205  
 573-474-2223

**GENERAL NOTES**

1. UTILITIES: LOCATION OF EXISTING UTILITIES, WHERE SHOWN, IS FOR INFORMATION ONLY AND IS NOT GUARANTEED TO BE ACCURATE OR COMPLETE. IT IS THE CONTRACTOR'S RESPONSIBILITY TO REQUEST UTILITY LOCATES FROM THE OWNER'S REPRESENTATIVE 72 HOURS PRIOR TO CONSTRUCTION AT INDIVIDUAL SITES.
2. SOIL BORINGS: SOIL BORING INFORMATION HAS NOT BEEN INCLUDED IN THE SPECIFICATIONS. IF THE CONTRACTOR DEEMS SUCH INVESTIGATIONS NECESSARY FOR THE PREPARATION OF THIS BID, HE SHALL BEAR ALL COSTS AND RESPONSIBILITY FOR SUCH INVESTIGATIONS. HE SHALL OBTAIN PERMISSION OF THE UNIVERSITY MISSOURI - (OWNER) TO OBTAIN SOIL BORINGS AND ANY BORING SHALL BE MADE IN ACCORDANCE WITH THE UNIVERSITY'S REQUIREMENTS. ANY RESULTING HOLES OR EXCAVATIONS SHALL BE BACKFILLED ACCORDING TO THE SPECIFICATIONS IMMEDIATELY UPON COMPLETION OF THE INVESTIGATION.
3. TREES AND SHRUBS: ALL TREES WITHIN THE GRADING LIMITS SHALL BE PROTECTED FROM DAMAGE WITH CONSTRUCTION FENCING UNLESS SPECIFICALLY NOTED TO BE REMOVED.
4. ALL EXISTING IMPROVEMENTS IN CONFLICT WITH PROPOSED CONSTRUCTION SHALL BE REMOVED AND DISPOSED OF AWAY FROM THE SITE.
  - A. THIS WORK SHALL CONSIST OF REMOVING PAVEMENTS, SURFACING AND BASE COURSES OF ALL TYPES, PARKING BLOCKS, WHEEL STOPS, OBJECTS AND OTHER EXISTING IMPROVEMENTS, WHICH CONFLICT WITH THE WORK.
  - B. OLD PAVEMENTS OR OTHER OBSTRUCTIONS TO THE CONSTRUCTION OF THE PAVEMENTS AND NOT DESIGNATED OR PERMITTED TO REMAIN SHALL BE REMOVED AND DISPOSED OF BY THE CONTRACTOR.
  - C. IN REMOVING PAVEMENT AND OTHER SIMILAR IMPROVEMENTS AND WHERE A PORTION OF SUCH IMPROVEMENTS IS TO BE LEFT IN PLACE, THEY SHALL BE REMOVED TO AN EXISTING JOINT. SUFFICIENT REMOVAL SHALL BE MADE TO PROVIDE FOR PROPER GRADE AND CONNECTIONS IN THE NEW WORK, WHICH MAY BE INDICATED ON THE PLANS.
  - D. THE CONTRACTOR SHALL NOT USE THE OWNER'S LANDFILL. DUMPING OR DISPOSAL OF EXCAVATED OR DEMOLISHED MATERIALS ON THE OWNER'S PROPERTY SHALL NOT BE PERMITTED. THE CONTRACTOR SHALL REMOVE AND LEGALLY DISPOSE OF EXCAVATED OR DEMOLISHED MATERIALS OFF THE OWNER'S PROPERTY.
5. CONTRACTOR SHALL NOT DISTURB LAWN AREAS. IF LAWN AREAS ARE DISTURBED, REFER TO SPECIFICATIONS.
6. DIMENSIONS ON DRAWINGS ARE GENERALLY BASED UPON TOPOGRAPHIC SURVEYS. THE CONTRACTOR SHALL DETERMINE THE ACTUAL AMOUNT OF WORK, AND MAY WISH TO VERIFY DIMENSIONS, FOR HIS BID AND CONSTRUCTION PURPOSED. NO CHANGE IN CONTRACT PRICE WILL BE MADE FOR DISCREPANCIES BETWEEN ACTUAL AND SCALED DIMENSIONS.
7. THE CONTRACTOR SHALL USE CARE NOT TO SPLASH TACK OR SEAL COAT, OR OTHER ASPHALT MATERIALS ON CONCRETE SURFACES INCLUDING, BUT NOT LIMITED TO, CURB AND GUTTERS, WHEEL STOPS, OR CONCRETE DRIVES.
8. CONTRACTOR SHALL PROVIDE SIGNAGE, BARRICADES AND / OR FLAGMEN, IN ACCORDANCE WITH THE MANUAL OF UNIFORM TRAFFIC CONTROL DEVICES DURING CONSTRUCTION OF IMPROVEMENTS. CONTRACTOR SHALL SUBMIT A TRAFFIC CONTROL PLAN TO THE ENGINEER AND OWNER PRIOR TO CONSTRUCTION ON A PARTICULAR LOT OR ROAD. THE ENGINEER OR OWNER MAY MODIFY THE TRAFFIC CONTROL PLAN AT NO ADDITIONAL COST TO THE PROJECT.
9. THE COORDINATES FOR THE FAILED AREAS ARE PROVIDED TO SHOW GENERAL LOCATIONS ONLY. THE EXACT LOCATION SHALL BE DETERMINED BY THE OWNERS REPRESENTATIVE.
10. THE CONTRACTOR SHALL COORDINATE THE STRIPING ON THE LOTS WITH THE OWNER AND OWNER'S REPRESENTATIVE.
11. CONTRACTOR SHALL NOT PAVE OVER EXISTING MANHOLES OR VALVE COVERS.

**2024 SCHEDULE / UNIVERSITY ACTIVITIES**

12. THE CONTRACTOR SHALL SCHEDULE CONSTRUCTION TO MINIMIZE DISRUPTION OF THE FOLLOWING SCHEDULED UNIVERSITY EVENTS. SCHEDULING SHALL COMPLY WITH THE REQUIREMENTS IN THE CONTRACT SPECIAL CONDITIONS.
 

A. 2024 COMMENCEMENT	MAY 10, 2024 - MAY 12, 2024
B. COLUMBIA PUBLIC SCHOOLS GRADUATION	MAY 23, 2024 - MAY 24, 2024
C. SENIOR SHOW ME STATE GAMES	JUNE 6, 2024 - JUNE 9, 2024
D. SHOW ME STATE GAMES	JULY 19, 2024 - JULY 21, 2024 JULY 26, 2024 - JULY 28, 2024

**BID SET ISSUED: 03/25/2024**

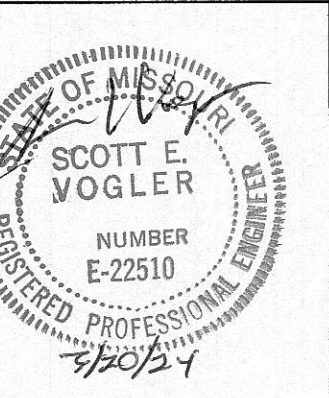

NO.	DATE	REVISION DESCRIPTION	BY

**MECO**  
 ENGINEERING CO., INC.

meceoengineering.com  
 MO Engineering Lic. #000898 - IL Design Firm #184-001749

**OFFICE LOCATIONS**  
 HANNIBAL, MO  
 JEFFERSON CITY, MO  
 BRANSON, MO  
 BOONVILLE, MO  
 PITTSFIELD, IL

THE PROFESSIONAL WHOSE SIGNATURE AND PERSONAL SEAL APPEARS ON THIS SHEET ASSUMES RESPONSIBILITY ONLY FOR WHAT APPEARS ON THIS PAGE, AND DISCLAIMS (PURSUANT TO SECTION 327.411 RSMO) & (PURSUANT TO 225 ILCS 325/PROFESSIONAL ENGINEERING PRACTICE ACT OF 1989) ANY RESPONSIBILITY FOR ALL OTHER PLANS, SPECIFICATIONS, ESTIMATES, REPORTS, OR OTHER DOCUMENTS OR INSTRUMENTS NOT SEALED BY THE UNDERSIGNED PROFESSIONAL RELATING TO OR INTENDED TO BE USED FOR ANY PART, OR PARTS OF THE PROJECT TO WHICH THIS PAGE REFERS.

**VARIOUS LOCATIONS**  
**FY24 SUMMER PAVING PROJECT - CONCRETE**  
**UNIVERSITY OF MISSOURI PROJECT NO. CP241343**

SURVEYED	DESIGNED	DRAWN	CHECKED	APPROVED	RELEASED
	SEV	EW/TN			

**STANDARD NOTES**

SCALE	DRAWING NAME	PROJECT NUMBER	SHEET NO.
NOT TO SCALE	C-002-C	CP241343 473-070	2

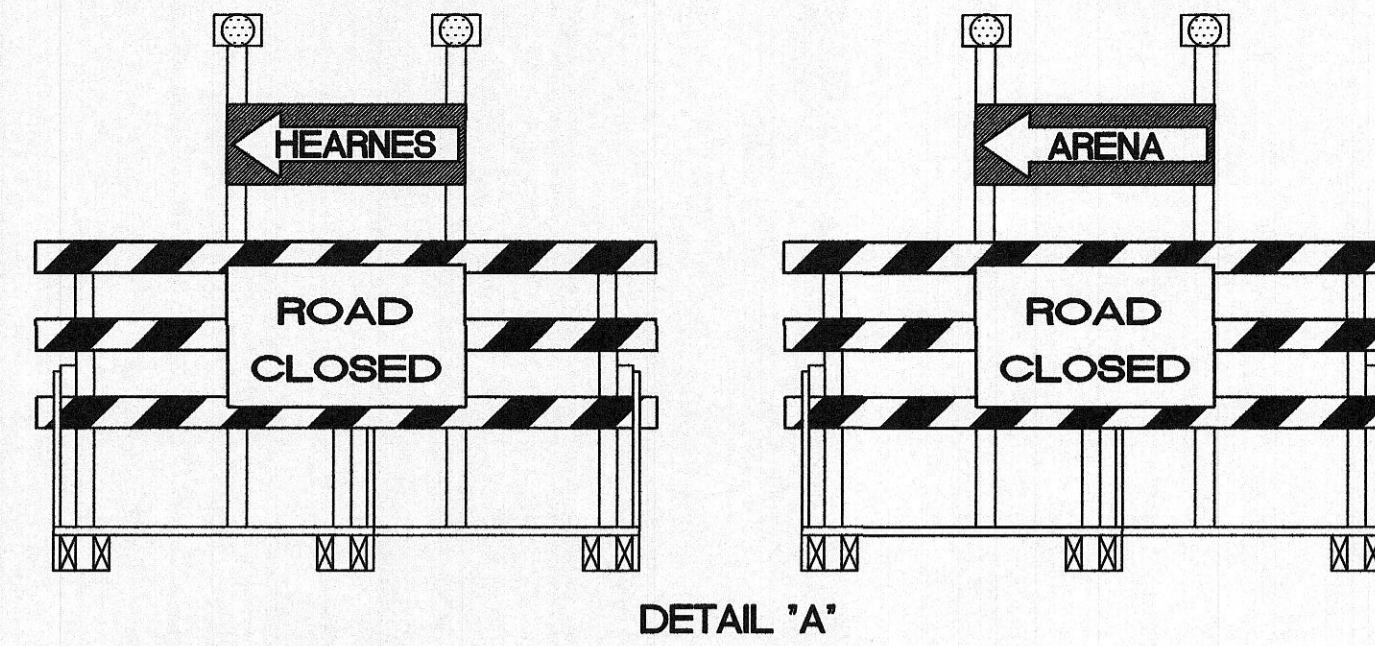
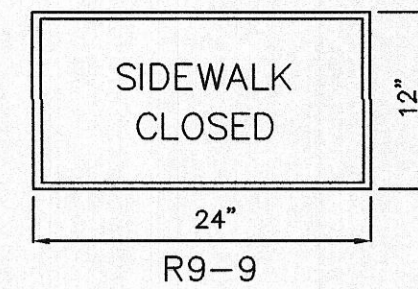
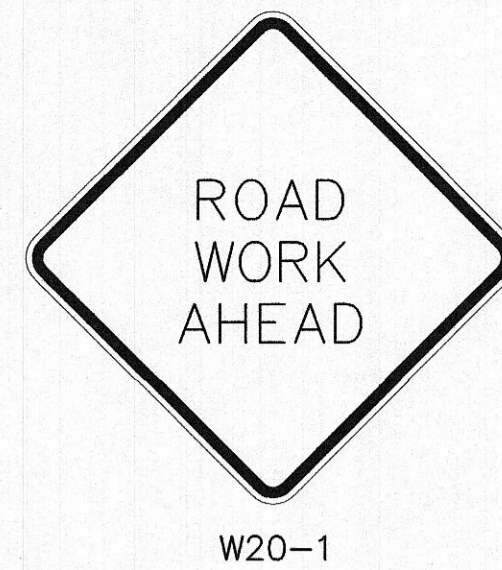

SIGN SUMMARY						
SIGN	SIZE INCHES	AREA SQ. FT.	QUANTITY	TOTAL AREA SQ. FT.	SIGN LEGEND	
WARNING SIGNS						
①	W20-1	48" X 48"	16.0	6	96	ROAD WORK AHEAD
②	R9-9	24" X 12"	2.0	3	6	SIDEWALK CLOSED
③	W1-1R	48" X 48"	16.0	2	32	DETOUR RIGHT TURN
④	W16-9P	30" X 18"	3.75	2	7.5	DETOUR SIGN
CONSTRUCTION SIGNS				141.5	SQ. FT. TOTAL	

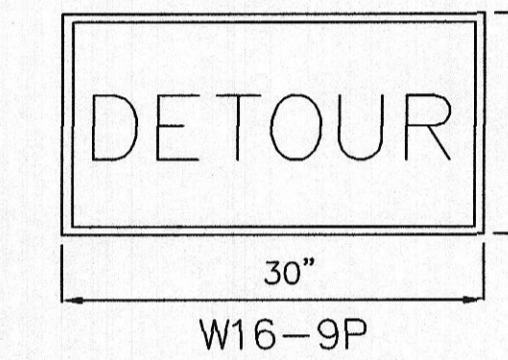
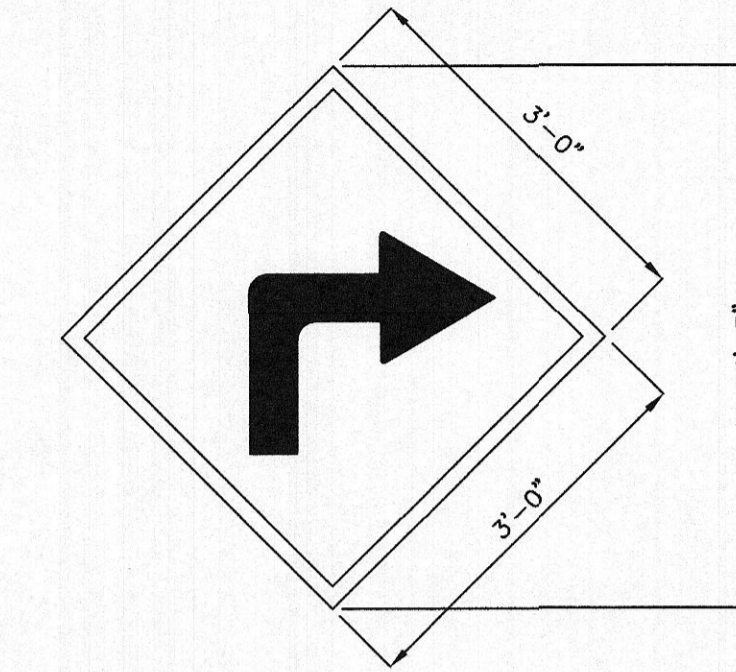

**616.8.35 (TA-3S) Stationary Shoulder Work**

SPEED Posted (mph)	SIGN SPACING (ft.)		TAPER LENGTH (ft.)		RECOMMENDED CHANNELIZER SPACING (ft.)	
	Undivided (S)	Shoulder (T1)	Lane (T2)	Buffer Length (B)	Tapers	Buffer/Work Areas
0-35	200	70	-	250	35	40
40-45	350	150	-	360	40	80
50-55	500	185	-	495	50	80
60-70	1000	235	-	730	60	120

1. Shoulder taper length based on 10 ft. (standard shoulder width) offset. 2. Lane taper length based on 12 ft. (standard lane width) offset.

TYPE OF ROADWAY	SIGN HEIGHT (MINIMUM)	MAXIMUM WORK ZONE LENGTH (L)	Channelizer	Protective Vehicle
URBAN	7' Post	1 MI.	Sign Flashing Arrow Panel	Truck Mounted Attenuator (TMA)
RURAL DIVIDED	7' Post	2 MI.		Work Space
VEHICLE	48 inches Recommended	-		

Date:  
Type of Work:  
Location:  
Work Zone Specialist:  
Field Notes:

Page 2 of 3 9/2023

FRONT ELEVATION

END ELEVATION

STRIPES ARE 6" WIDE ALTERNATING REFLECTORIZED ORANGE AND REFLECTORIZED WHITE. ALL REFLECTORIZED SURFACES SHALL BE TYPE 1 SHEETING. NO DIRECT PAYMENT WILL BE MADE FOR RELOCATION OF BARRICADES. STRIPES SHALL SLOPE DOWNWARD TOWARD THE SIDE TRAFFIC IS TO PASS.

**TYPE III MOVABLE BARRICADE UNIT**

18" MINIMUM

WARNING LIGHT

4" - 8"

36" APPROXIMATELY

DRUM

CHANNELIZER

STRIPES SHALL BE ALTERNATING HORIZONTAL REFLECTIVE ORANGE (TWO MINIMUM) AND REFLECTIVE WHITE (TWO MINIMUM) TYPE 2 REFLECTIVE SHEETING.

THE CONTRACTOR HAS THE OPTION TO USE FLEXIBLE OR REBOUNDABLE REFLECTIVE SHEETING WITH THE SAME MINIMUM REQUIREMENTS AS TYPE 2 REFLECTIVE SHEETING. NON-REFLECTORIZED ORANGE SPACES BETWEEN STRIPES SHALL BE NO GREATER THAN TWO INCHES.

NO DIRECT PAYMENT WILL BE MADE FOR RELOCATION OF DRUMS OR CHANNELIZERS.

DRUMS OR CHANNELIZERS SHALL BE USED DURING CONSTRUCTION FOR THE PROTECTION OF VEHICULAR TRAFFIC OR AS DIRECTED BY THE ENGINEER.

NOTES:

1. THE CONTRACTOR SHALL UTILIZE CONSTRUCTION SIGNS ONLY WHEN NECESSARY DUE TO CONSTRUCTION OPERATIONS. ALL SIGNS AND HANDLING OF TRAFFIC SHALL BE IN ACCORDANCE WITH MUTCD.
2. ALL SIGNS GREATER THAN 10 SQUARE FEET IN AREA SHALL BE MOUNTED ON TWO POSTS.
3. THE CONTRACTOR SHALL MODIFY THE TRAFFIC CONTROL PLAN TO FIT HIS CONSTRUCTION TECHNIQUE AND SCHEDULE. ANY MODIFIED TRAFFIC CONTROL PLAN SHALL BE APPROVED BY THE ENGINEER.
4. THE CONTRACTOR SHALL COORDINATE WITH THE OWNER'S REPRESENTATIVE AND PROVIDE ADEQUATE TRAFFIC CONTROL FOR ALL LOTS OR ROADS IN ACCORDANCE WITH MUTCD.

BID SET ISSUED: 03/25/2024

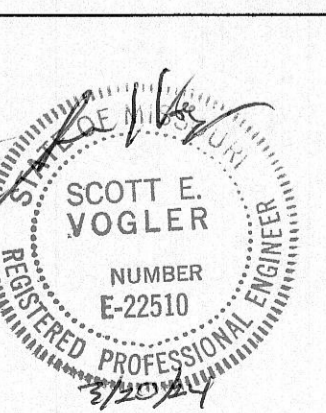

NO.	DATE	REVISION DESCRIPTION	BY	MECO ENGINEERING CO., INC.	OFFICE LOCATIONS HANNIBAL, MO JEFFERSON CITY, MO BRANSON, MO BOONVILLE, MO PITTSFIELD, IL	VARIOUS LOCATIONS FY24 SUMMER PAVING PROJECT - CONCRETE UNIVERSITY OF MISSOURI PROJECT NO. CP241343					SIGN LOCATION AND TRAFFIC CONTROL			
						SURVEYED	DESIGNED	DRAWN	CHECKED	APPROVED	RELEASED	SCALE	DRAWING NAME	PROJECT NUMBER
						SEV	EW/TN					TrafControl-C	CP241343 473-070	3

IF THIS DRAWING IS PLOTTED LESS THAN 24x36 IN SIZE, IT IS A REDUCED PLOT - SCALE SHOULD BE ADJUSTED ACCORDINGLY

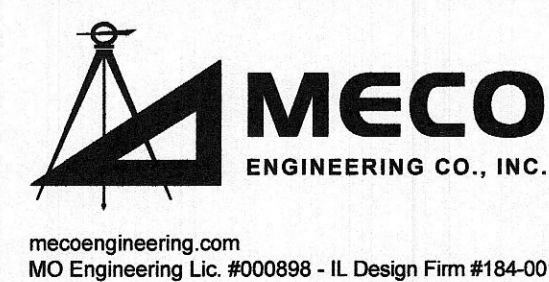

THE PROFESSIONAL WHOSE SIGNATURE AND PERSONAL SEAL APPEARS ON THIS SHEET ASSUMES RESPONSIBILITY ONLY FOR WHAT APPEARS ON THIS PAGE, AND DISCLAIMS (PURSUANT TO SECTION 327.411 RSMO) & (PURSUANT TO 225 ILCS 325/PROFESSIONAL ENGINEERING PRACTICE ACT OF 1989) ANY RESPONSIBILITY FOR ALL OTHER PLANS, SPECIFICATIONS, ESTIMATES, REPORTS, OR OTHER DOCUMENTS OR INSTRUMENTS NOT SEALED BY THE UNDERSIGNED PROFESSIONAL RELATING TO OR INTENDED TO BE USED FOR ANY PART, OR PARTS OF THE PROJECT TO WHICH THIS PAGE REFERS.

L:\MOE\p\2024\071\UMC 2024 Summer Paving - Design\DRAWINGS\CONCRETE PAVING\TrafControl-C.dwg, TRAFFIC, 3/28/2024 7:51:35 AM

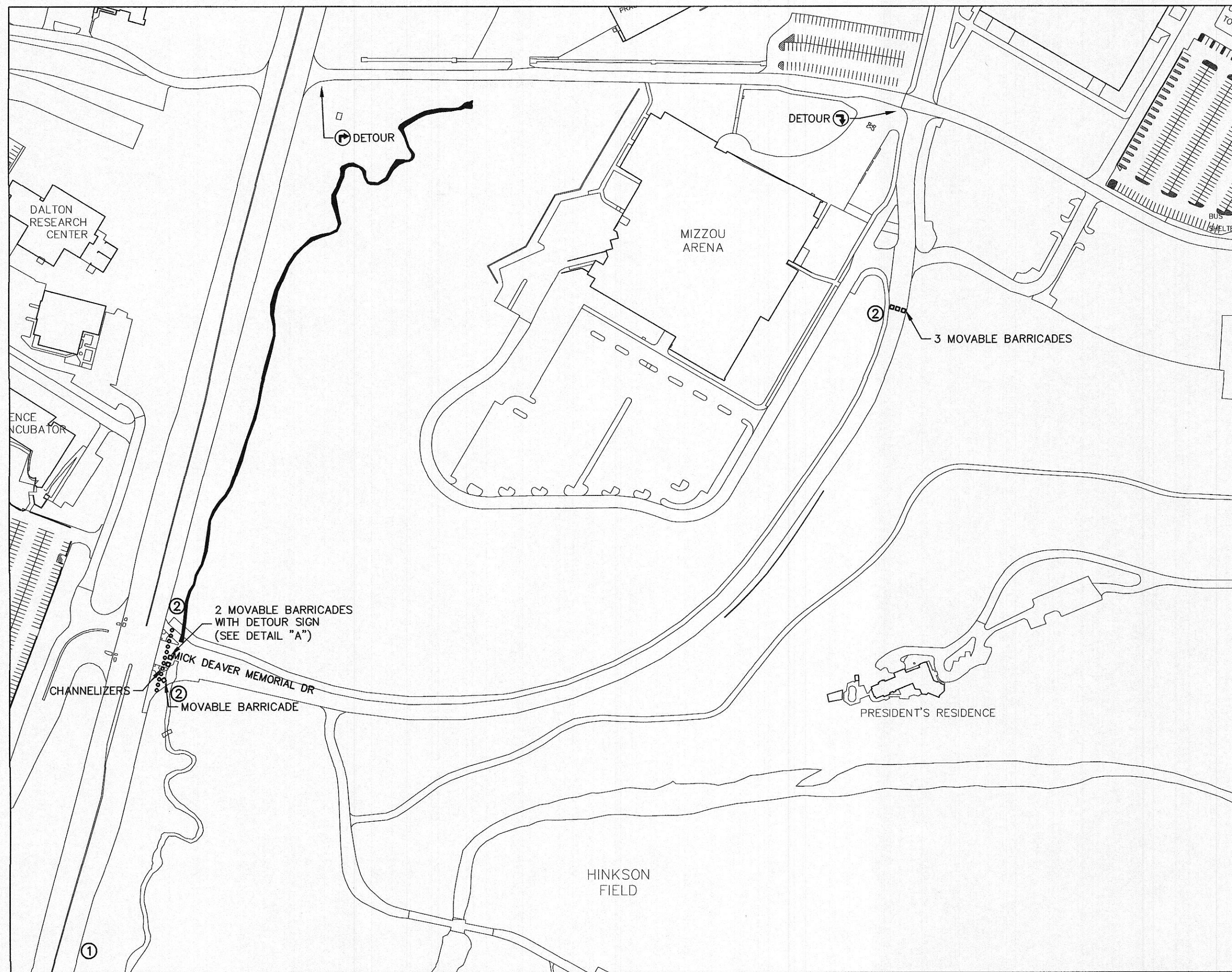

**MICK DEAVER REPAIRS**

- NOTES:
1. CONTRACTOR SHALL SHUT DOWN MICK DEAVER DRIVE FOR REPAIRS. CONTRACTOR SHALL SUBMIT TRAFFIC AND PEDESTRIAN CONTROL PLANS TO THE ENGINEER FOR APPROVAL PRIOR TO CONSTRUCTION.
  2. CONTRACTOR SHALL OBTAIN MODOT PERMIT TO WORK IN HWY R/W.

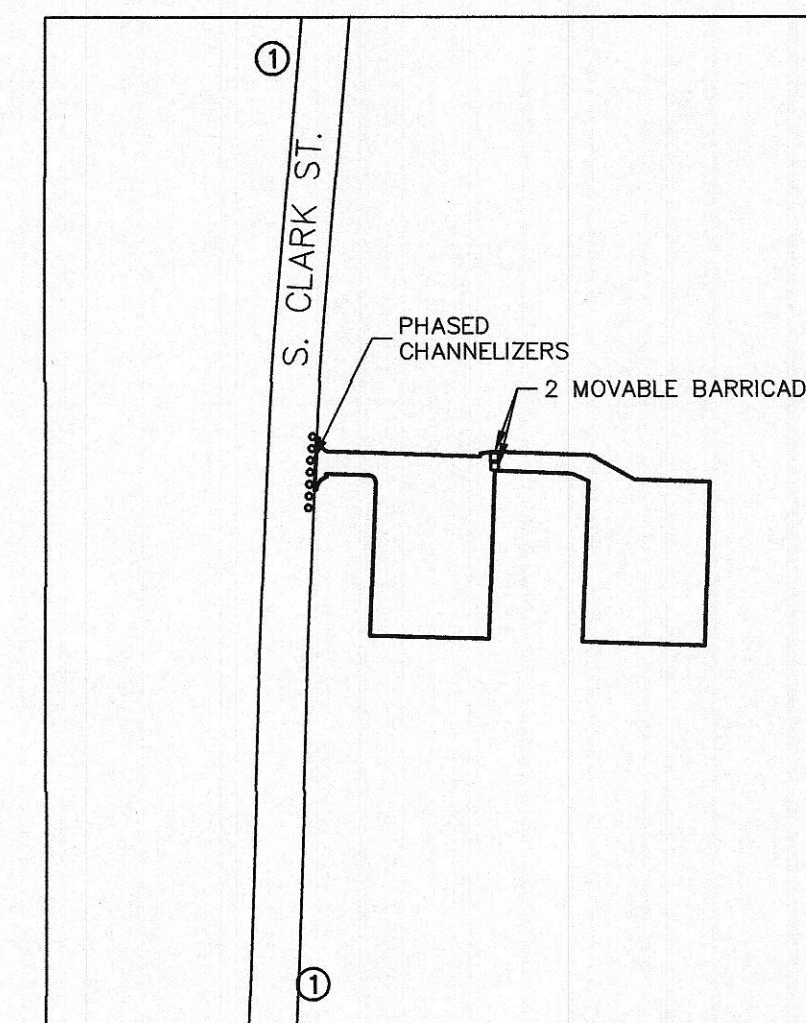

**AUDRAIN CLINIC REPAIRS**

- NOTES:
1. CONTRACTOR SHALL KEEP ONE LANE OF ENTRANCE OPEN DURING THE CONCRETE PAVEMENT REPLACEMENTS.
  2. CONTRACTOR SHALL OBTAIN CITY PERMIT TO WORK IN CITY R/W.

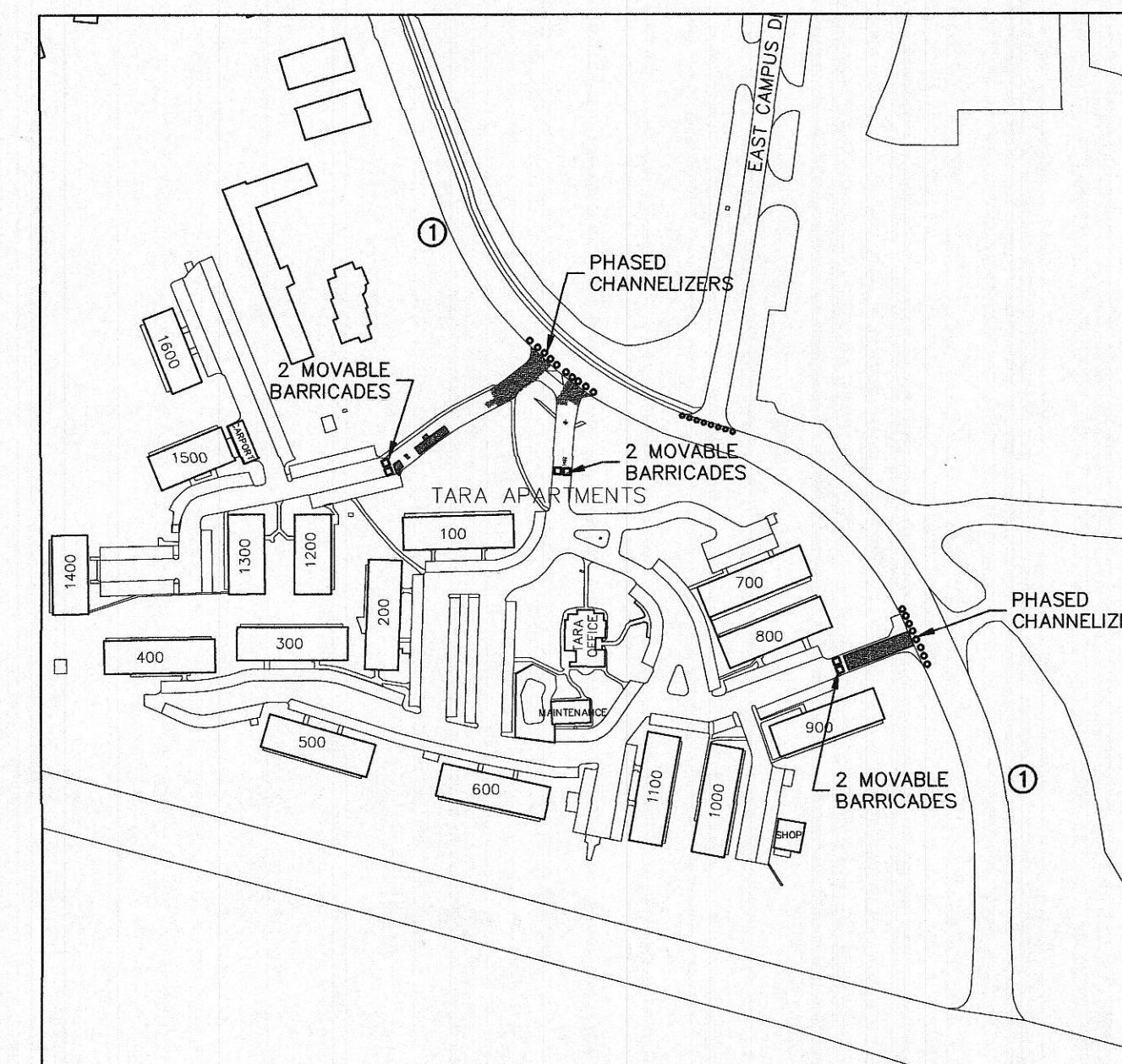

**TARA APARTMENT REPAIRS**

- NOTES:
1. CONTRACTOR SHALL KEEP ONE LANE OF ENTRANCE OPEN DURING THE CONCRETE PAVEMENT REPLACEMENTS.
  2. CONTRACTOR SHALL OBTAIN CITY PERMIT TO WORK IN CITY R/W.

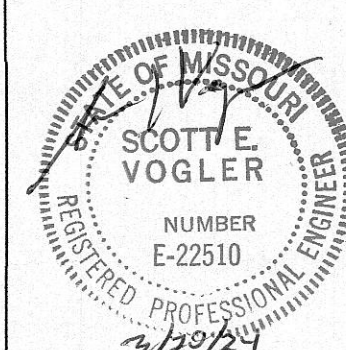

BID SET ISSUED: 03/25/2024

NO.	DATE	REVISION DESCRIPTION	BY

THE PROFESSIONAL WHOSE SIGNATURE AND PERSONAL SEAL APPEARS ON THIS SHEET ASSUMES RESPONSIBILITY ONLY FOR WHAT APPEARS ON THIS PAGE, AND DISCLAIMS (PURSUANT TO SECTION 327.411 RSMO) & (PURSUANT TO 225 ILCS 325/PROFESSIONAL ENGINEERING PRACTICE ACT OF 1989) ANY RESPONSIBILITY FOR ALL OTHER PLANS, SPECIFICATIONS, ESTIMATES, REPORTS, OR OTHER DOCUMENTS OR INSTRUMENTS NOT SEALED BY THE UNDERSIGNED PROFESSIONAL RELATING TO OR INTENDED TO BE USED FOR ANY PART, OR PARTS OF THE PROJECT TO WHICH THIS PAGE REFERS.

VARIOUS LOCATIONS					
FY24 SUMMER PAVING PROJECT - CONCRETE					
UNIVERSITY OF MISSOURI PROJECT NO. CP241343					
SURVEYED	DESIGNED	DRAWN	CHECKED	APPROVED	RELEASED
	SEV	EW/TN			

SIGN LOCATION AND TRAFFIC CONTROL			
SCALE	DRAWING NAME	PROJECT NUMBER	SHEET NO.
	TrafControl-C	CP241343 473-070	4

L:\2024\Projects\CP241343\FY24 Summer Paving - Design\DWG\MISSOURI CONCRETE PAVING\TRAFFIC CONTROL\CP241343-070.dwg, 11/15/2024, 2:15:00 PM

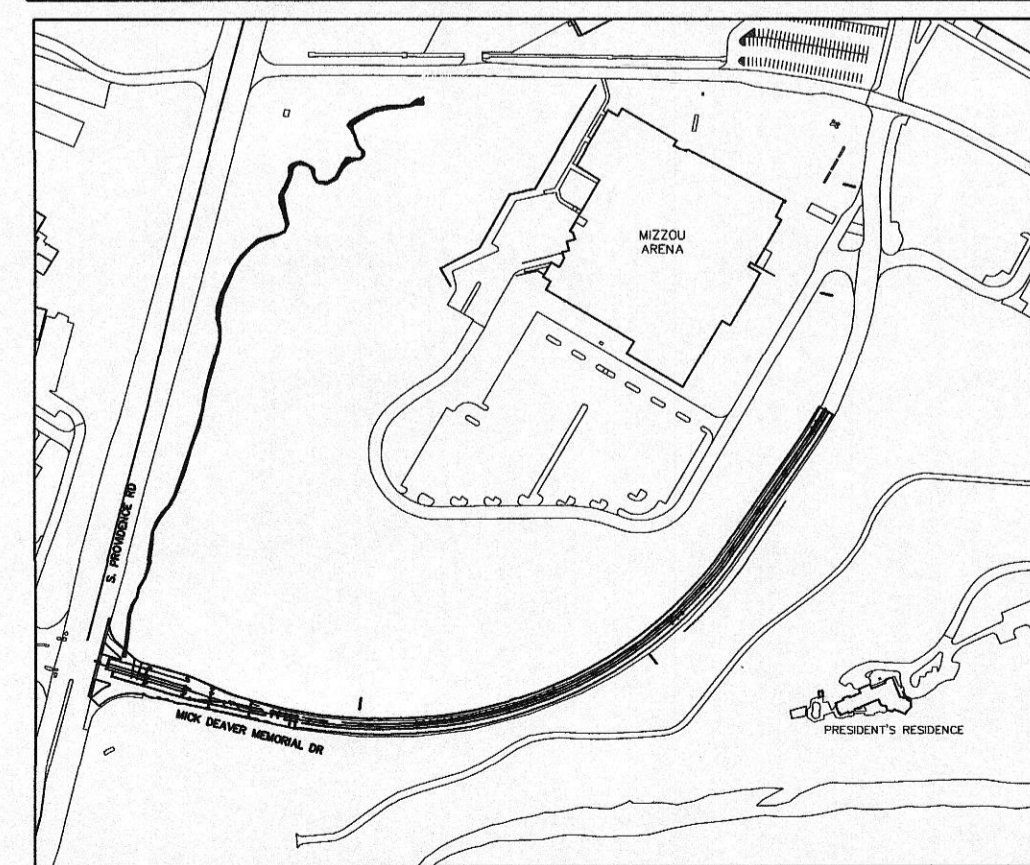
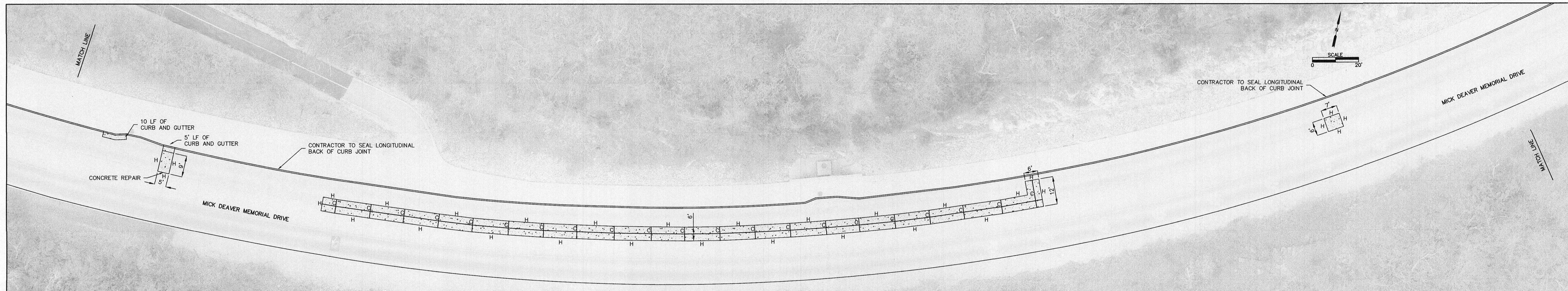
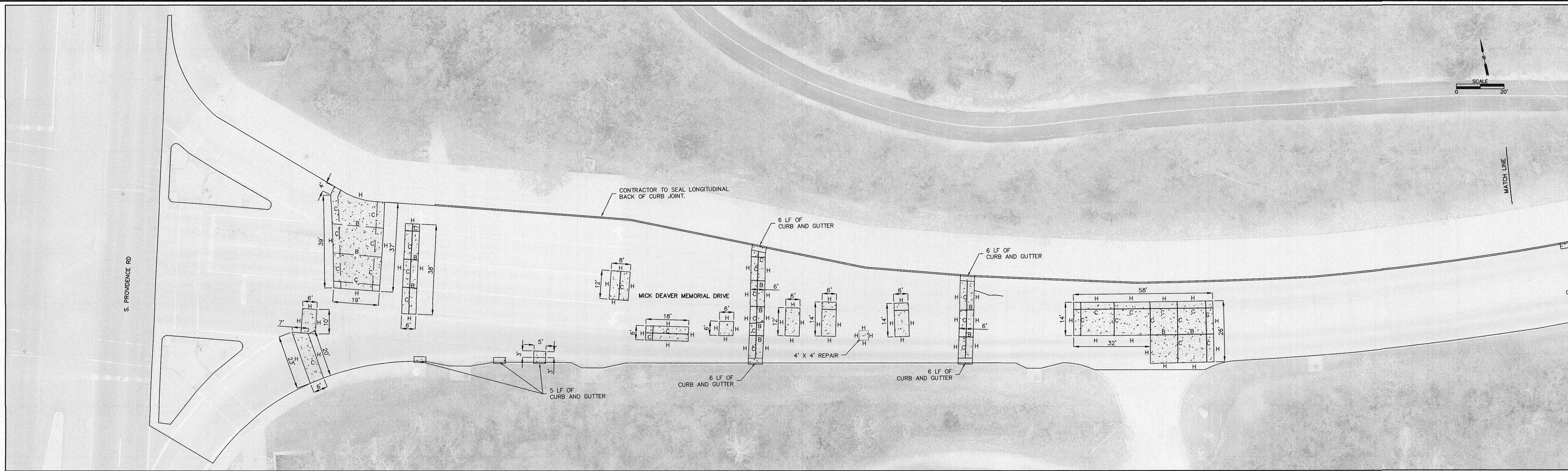

**NOTES:**

- CONTRACTOR SHALL SAWCUT AND REMOVE EXISTING CONCRETE PAVEMENT AS SHOWN.
- CONTRACTOR SHALL REVIEW SHEET NO. 12 FOR DETAILS OF CONSTRUCTION ON THIS DRIVE.

**NOTES TO THE CONTRACTOR:**

Underground facilities, structures, and utilities have been plotted from available surveys and records and therefore, their locations must be considered approximate only. There may be others, the existence of which is at present not known. Verification of the locations of underground utilities, shown or not shown, will be the responsibility of the construction contractor.  
 The contractor shall make suitable and timely requests to all utility owners, pipeline owners, or other parties affected to have all necessary adjustments of public or private utilities, pipe lines, or other appurtenances within, or adjacent to the limits of construction, as soon as practical or possible.

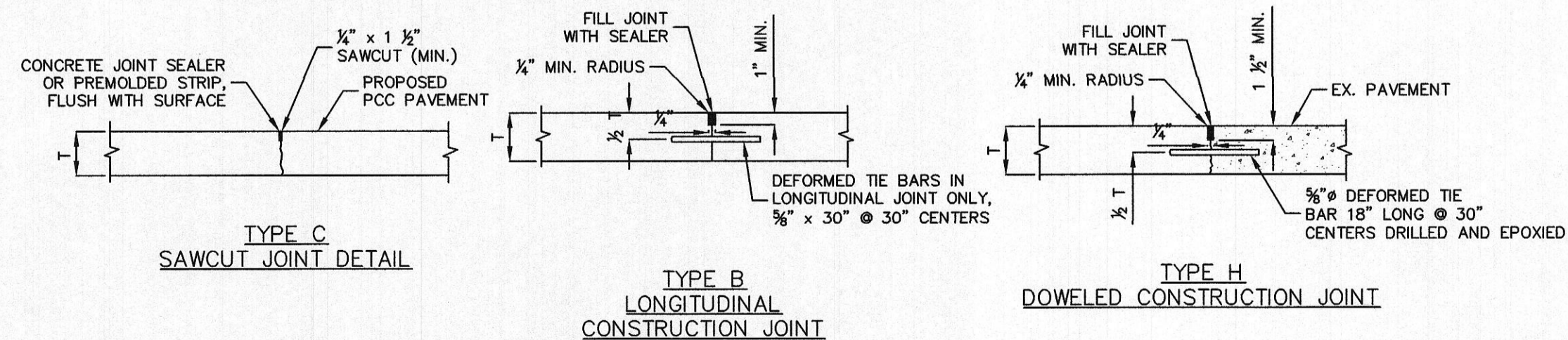

**LEGEND:**

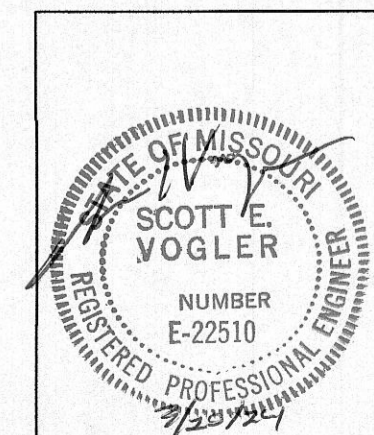
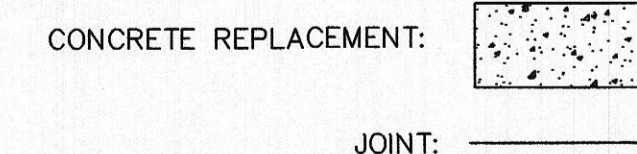

**BID SET ISSUED: 03/25/2024**

NO.	DATE	REVISION DESCRIPTION	BY



**OFFICE LOCATIONS**  
 HANBIBAL, MO  
 JEFFERSON CITY, MO  
 BRANSON, MO  
 BOONVILLE, MO  
 PITTSFIELD, IL

THE PROFESSIONAL WHOSE SIGNATURE AND PERSONAL SEAL APPEARS ON THIS SHEET ASSUMES RESPONSIBILITY ONLY FOR WHAT APPEARS ON THIS PAGE, AND DISCLAIMS (PURSUANT TO SECTION 327.411 RSMO) & (PURSUANT TO 225 ILCS 325/PROFESSIONAL ENGINEERING PRACTICE ACT OF 1989) ANY RESPONSIBILITY FOR ALL OTHER PLANS, SPECIFICATIONS, ESTIMATES, REPORTS, OR OTHER DOCUMENTS OR INSTRUMENTS NOT SEALED BY THE UNDERSIGNED PROFESSIONAL RELATING TO OR INTENDED TO BE USED FOR ANY PART, OR PARTS OF THE PROJECT TO WHICH THIS PAGE REFERS.

VARIOUS LOCATIONS					
FY24 SUMMER PAVING PROJECT - CONCRETE					
UNIVERSITY OF MISSOURI PROJECT NO. CP241343					
SURVEYED	DESIGNED	DRAWN	CHECKED	APPROVED	RELEASED
	SEV	EW/TN			

MICK DEAVER MEMORIAL DRIVE REPAIR PLAN			
SCALE	DRAWING NAME	PROJECT NUMBER	SHEET NO.
	MickDeaver-C	CP241343 473-070	5

L:\Projects\CP241343\CP241343.dwg - 3/25/2024 10:30 AM

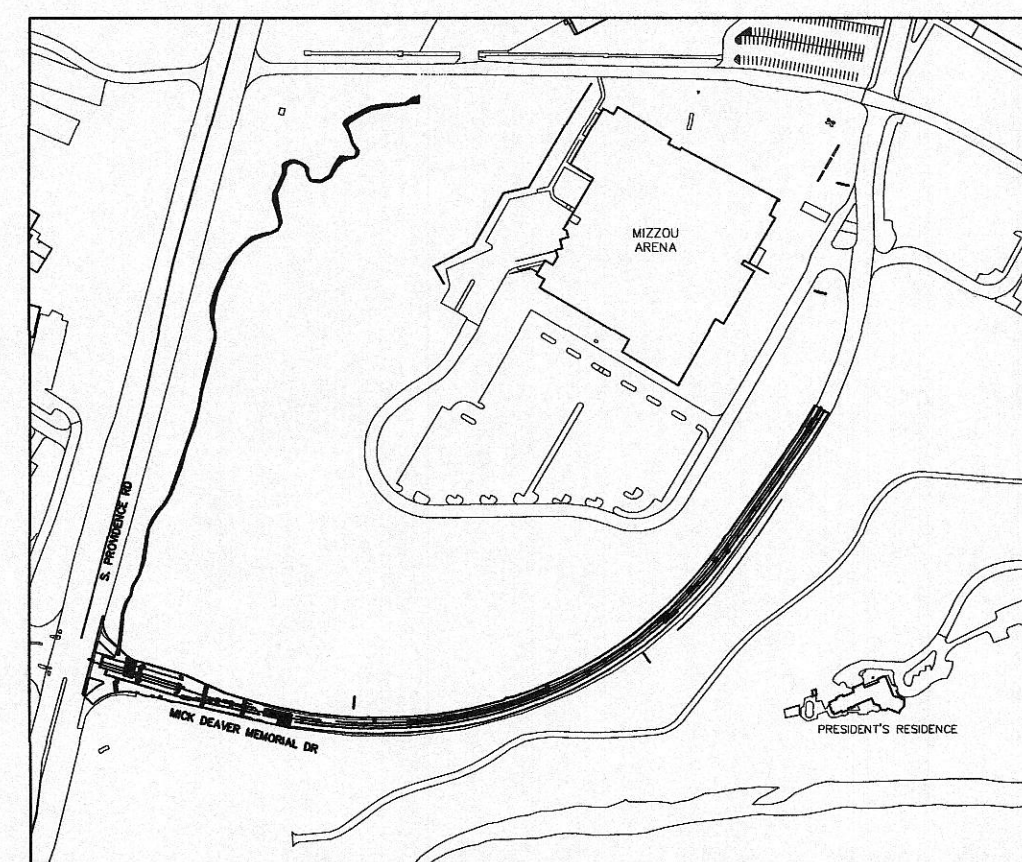
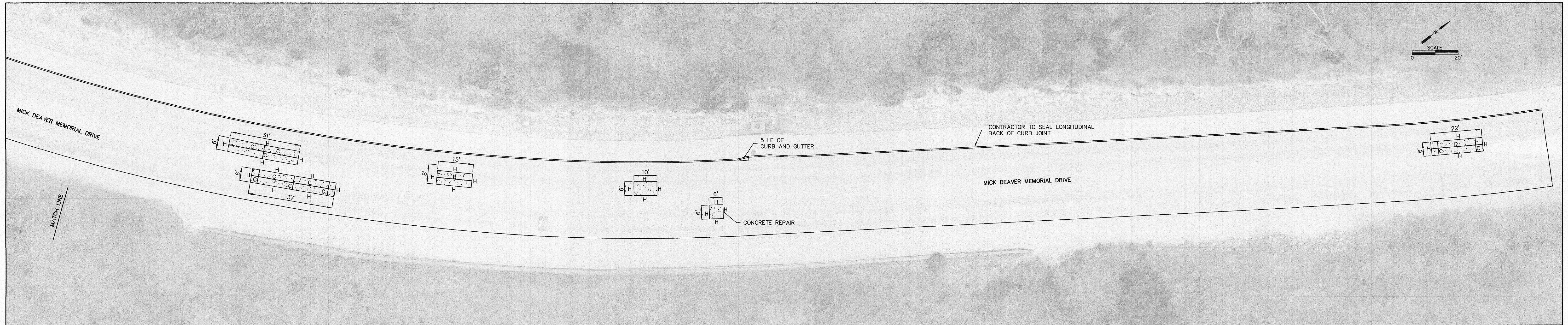

**NOTES:**

1. CONTRACTOR SHALL SAWCUT AND REMOVE EXISTING CONCRETE PAVEMENT AS SHOWN.
2. CONTRACTOR SHALL REVIEW SHEET NO. 12 FOR DETAILS OF CONSTRUCTION ON THIS DRIVE.
3. CONTRACTOR SHALL REVIEW JOINT DETAILS ON SHEET 5

**NOTES TO THE CONTRACTOR:**

Underground facilities, structures, and utilities have been plotted from available surveys and records and therefore, their locations must be considered approximate only. There may be others, the existence of which is at present not known. Verification of the locations of underground utilities, shown or not shown, will be the responsibility of the construction contractor.

The contractor shall make suitable and timely requests to all utility owners, pipeline owners, or other parties affected to have all necessary adjustments of public or private utilities, pipe lines, or other appurtenances within, or adjacent to the limits of construction, as soon as practical or possible.

**LEGEND:**

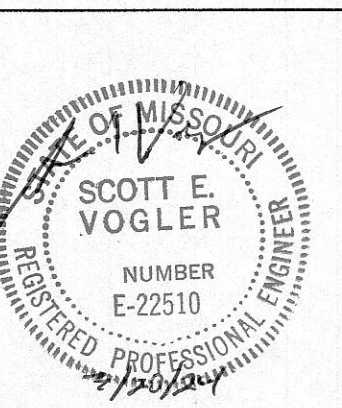
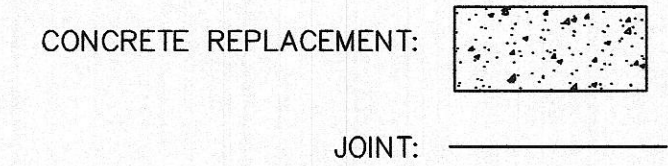

**BID SET ISSUED: 03/25/2024**

NO.	DATE	REVISION DESCRIPTION	BY

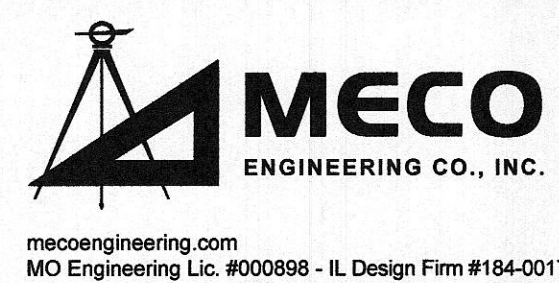

OFFICE LOCATIONS  
 HANNIBAL, MO  
 JEFFERSON CITY, MO  
 BRANSON, MO  
 BOONVILLE, MO  
 PITTSFIELD, IL

THE PROFESSIONAL WHOSE SIGNATURE AND PERSONAL SEAL APPEARS ON THIS SHEET ASSUMES RESPONSIBILITY ONLY FOR WHAT APPEARS ON THIS PAGE, AND DISCLAIMS (PURSUANT TO SECTION 327.411 RSMO) & (PURSUANT TO 225 ILCS 325/PROFESSIONAL ENGINEERING PRACTICE ACT OF 1989) ANY RESPONSIBILITY FOR ALL OTHER PLANS, SPECIFICATIONS, ESTIMATES, REPORTS, OR OTHER DOCUMENTS OR INSTRUMENTS NOT SEALED BY THE UNDERSIGNED PROFESSIONAL RELATING TO OR INTENDED TO BE USED FOR ANY PART, OR PARTS OF THE PROJECT TO WHICH THIS PAGE REFERS.

VARIOUS LOCATIONS FY24 SUMMER PAVING PROJECT - CONCRETE UNIVERSITY OF MISSOURI PROJECT NO. CP241343					
SURVEYED	DESIGNED	DRAWN	CHECKED	APPROVED	RELEASED
	SEV	EW/TN			

MICK DEAVER MEMORIAL DRIVE REPAIR PLAN			
SCALE	DRAWING NAME	PROJECT NUMBER	SHEET NO.
	MickDeaver-C	CP241343 473-070	6

L:\AD\Projects\17\1701 UNC 2024 Summer Paving - Design\Drawings\CONCRETE REPAIR\C-MickDeaver-C.dwg, REPAIR\_3, 3/16/2024 7:28:43 AM

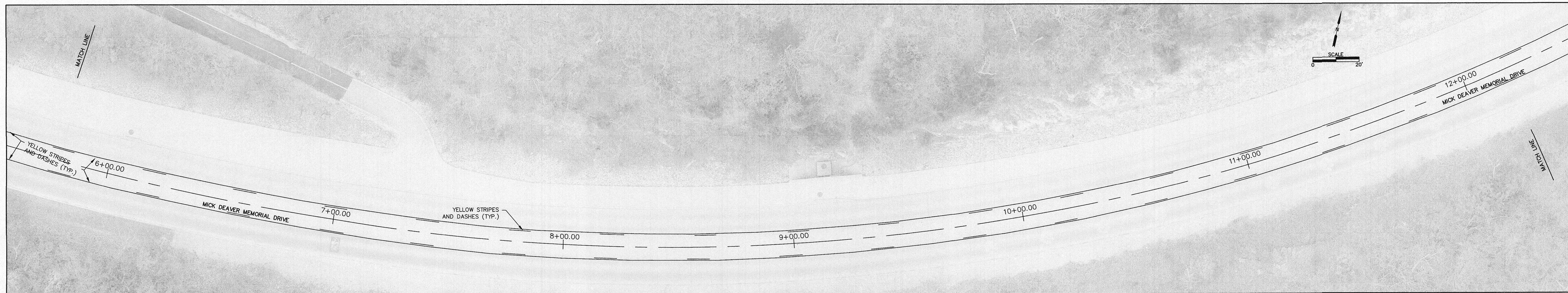
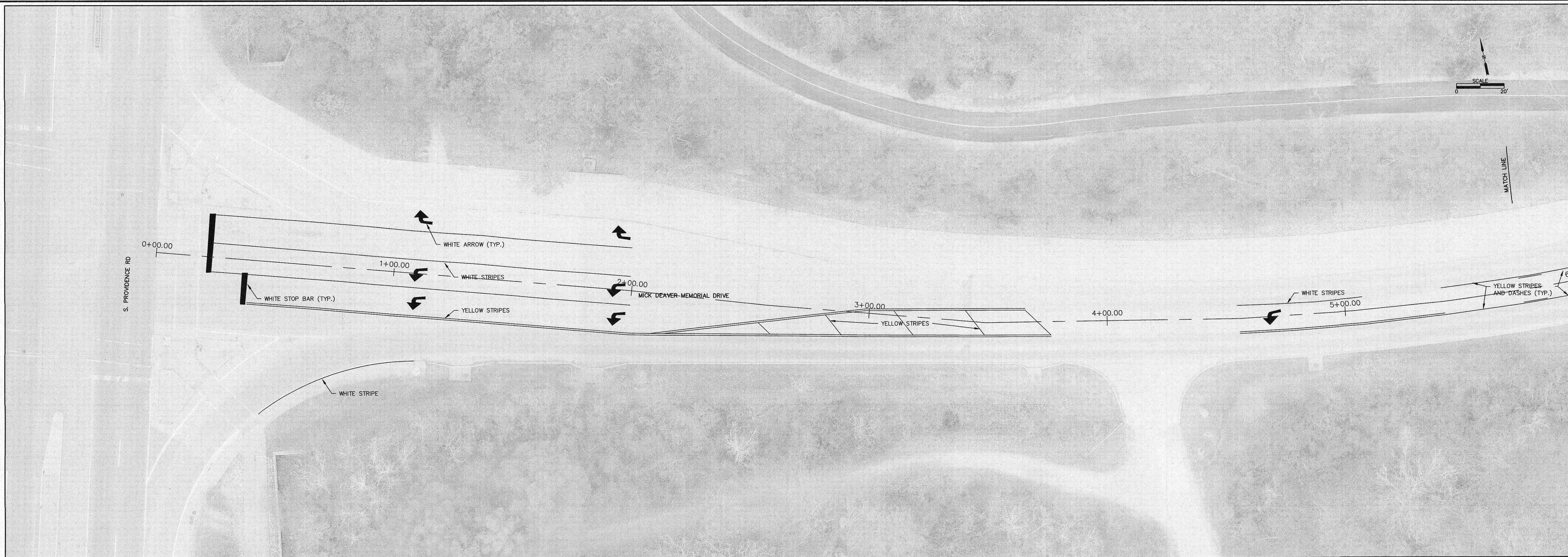

**NOTES:**

1. CONTRACTOR SHALL REVIEW SHEET NO. 12 FOR STRIPING DETAILS ON THIS DRIVE.

BID SET ISSUED: 03/25/2024

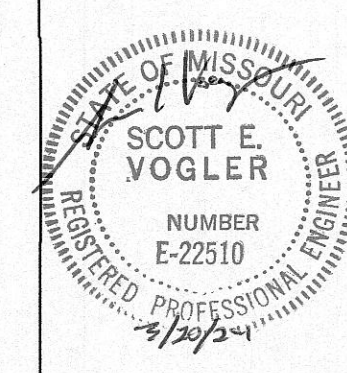

NO.	DATE	REVISION DESCRIPTION	BY

**MECO**  
ENGINEERING CO., INC.

mecoengineering.com  
MO Engineering Lic. #000898 - IL Design Firm #184-001749

OFFICE LOCATIONS  
HANNIBAL, MO  
JEFFERSON CITY, MO  
BRANSON, MO  
BOONVILLE, MO  
PITTSFIELD, IL

THE PROFESSIONAL WHOSE SIGNATURE AND PERSONAL SEAL APPEARS ON THIS SHEET ASSUMES RESPONSIBILITY ONLY FOR WHAT APPEARS ON THIS PAGE, AND DISCLAIMS (PURSUANT TO SECTION 327.411 RSMO) & (PURSUANT TO 225 ILCS 325/PROFESSIONAL ENGINEERING PRACTICE ACT OF 1989) ANY RESPONSIBILITY FOR ALL OTHER PLANS, SPECIFICATIONS, ESTIMATES, REPORTS, OR OTHER DOCUMENTS OR INSTRUMENTS NOT SEALED BY THE UNDERSIGNED PROFESSIONAL RELATING TO OR INTENDED TO BE USED FOR ANY PART, OR PARTS OF THE PROJECT TO WHICH THIS PAGE REFERS.

VARIOUS LOCATIONS FY24 SUMMER PAVING PROJECT - CONCRETE UNIVERSITY OF MISSOURI PROJECT NO. CP241343						
SURVEYED	DESIGNED	DRAWN	CHECKED	APPROVED	RELEASED	
	SEV	EW/TN				

MICK DEAVER MEMORIAL DRIVE STRIPING PLAN			
SCALE	DRAWING NAME	PROJECT NUMBER	SHEET NO.
	MickDeaver-C	CP241343 473-070	7

L:\000\paving\CP241343\MOE\2024 Summer Paving - Design\MOE\MSDC\CONCRETE\PAVING\MECO\MECO-01749-01.dwg, STRIPING, 1/31/2024, 1:20:30 AM

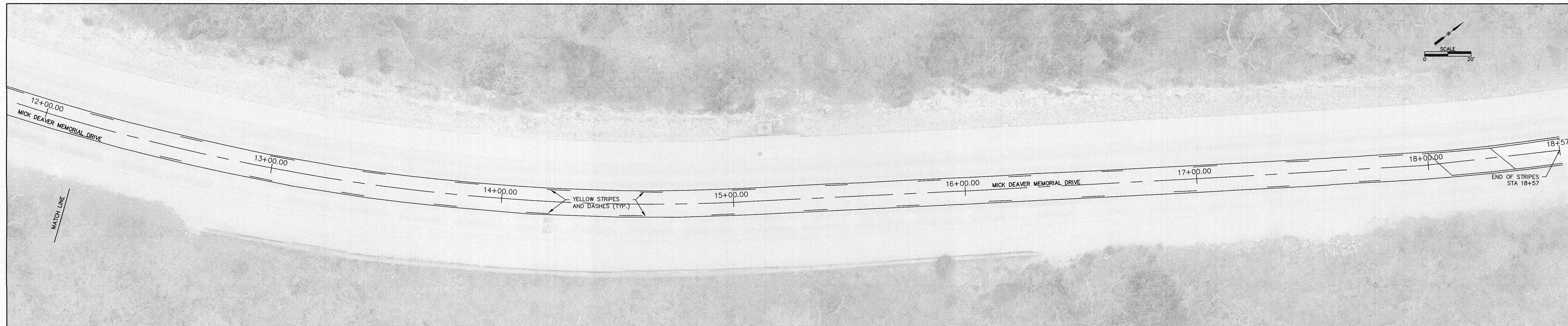

**NOTES:**

- CONTRACTOR SHALL REVIEW SHEET NO. 12 FOR STRIPING DETAILS ON THIS DRIVE.

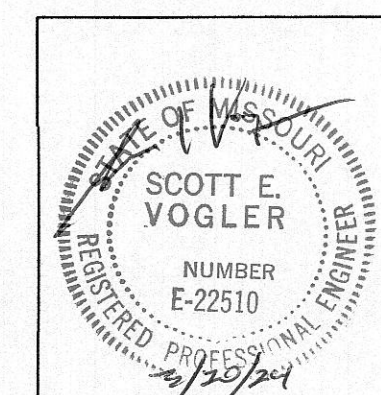

BID SET ISSUED: 03/25/2024

IF THIS DRAWING IS PLOTTED LESS THAN 24x36 IN SIZE, IT IS A REDUCED PLOT - SCALE SHOULD BE ADJUSTED ACCORDINGLY	NO.	DATE	REVISION DESCRIPTION	BY	 mecoengineering.com MO Engineering Lic. #000898 - IL Design Firm #184-001749	OFFICE LOCATIONS HANBESL, MO JEFFERSON CITY, MO BRANSON, MO BOONVILLE, MO PITTSFIELD, IL	THE PROFESSIONAL WHOSE SIGNATURE AND PERSONAL SEAL APPEARS ON THIS SHEET ASSUMES RESPONSIBILITY ONLY FOR WHAT APPEARS ON THIS PAGE, AND DISCLAIMS (PURSUANT TO SECTION 327.411 RSMO) & (PURSUANT TO 225 ILCS 325/PROFESSIONAL ENGINEERING PRACTICE ACT OF 1989) ANY RESPONSIBILITY FOR ALL OTHER PLANS, SPECIFICATIONS, ESTIMATES, REPORTS, OR OTHER DOCUMENTS OR INSTRUMENTS NOT SEALED BY THE UNDERSIGNED PROFESSIONAL RELATING TO OR INTENDED TO BE USED FOR ANY PART, OR PARTS OF THE PROJECT TO WHICH THIS PAGE REFERS.	<b>VARIOUS LOCATIONS</b> <b>FY24 SUMMER PAVING PROJECT - CONCRETE</b> <b>UNIVERSITY OF MISSOURI PROJECT NO. CP241343</b>						<b>MICK DEAVER MEMORIAL DRIVE</b> <b>STRIPING PLAN</b>							
									<table border="1"> <tr> <td>SURVEYED</td> <td>DESIGNED</td> <td>DRAWN</td> <td>CHECKED</td> <td>APPROVED</td> <td>RELEASED</td> </tr> <tr> <td></td> <td>SEV</td> <td>EW/TN</td> <td></td> <td></td> <td></td> </tr> </table>	SURVEYED	DESIGNED	DRAWN	CHECKED	APPROVED	RELEASED		SEV	EW/TN			
SURVEYED	DESIGNED	DRAWN	CHECKED	APPROVED	RELEASED																
	SEV	EW/TN																			
								MickDeaver-C	CP241343 473-070	8											

L:\MO-Projects\CP241343\FY24 Summer Paving - Design\DRAWINGS\CONCRETE PAVEMENT\STRIPING\CP241343\_032524.dwg, STRIPING, 3/25/2024 7:54:15 AM



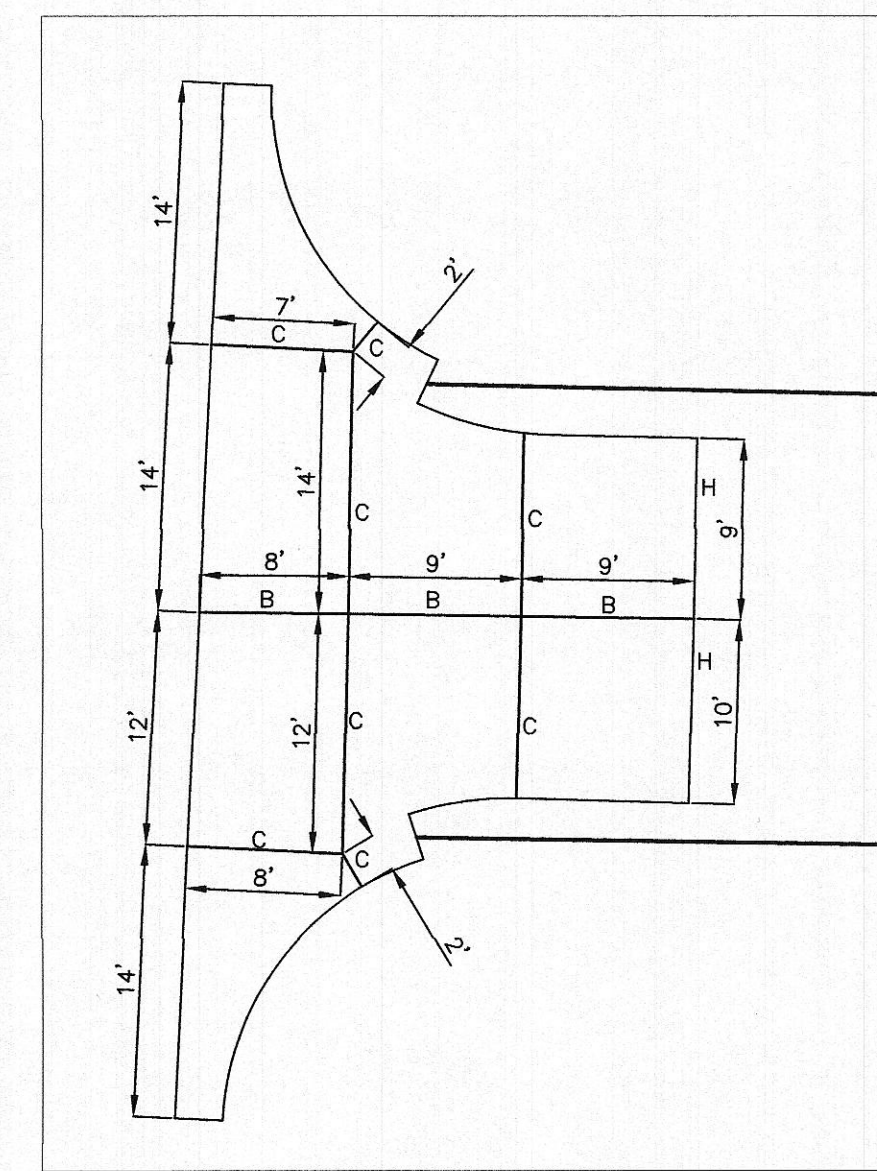

CONCRETE JOINT LAYOUT  
NOTE 4

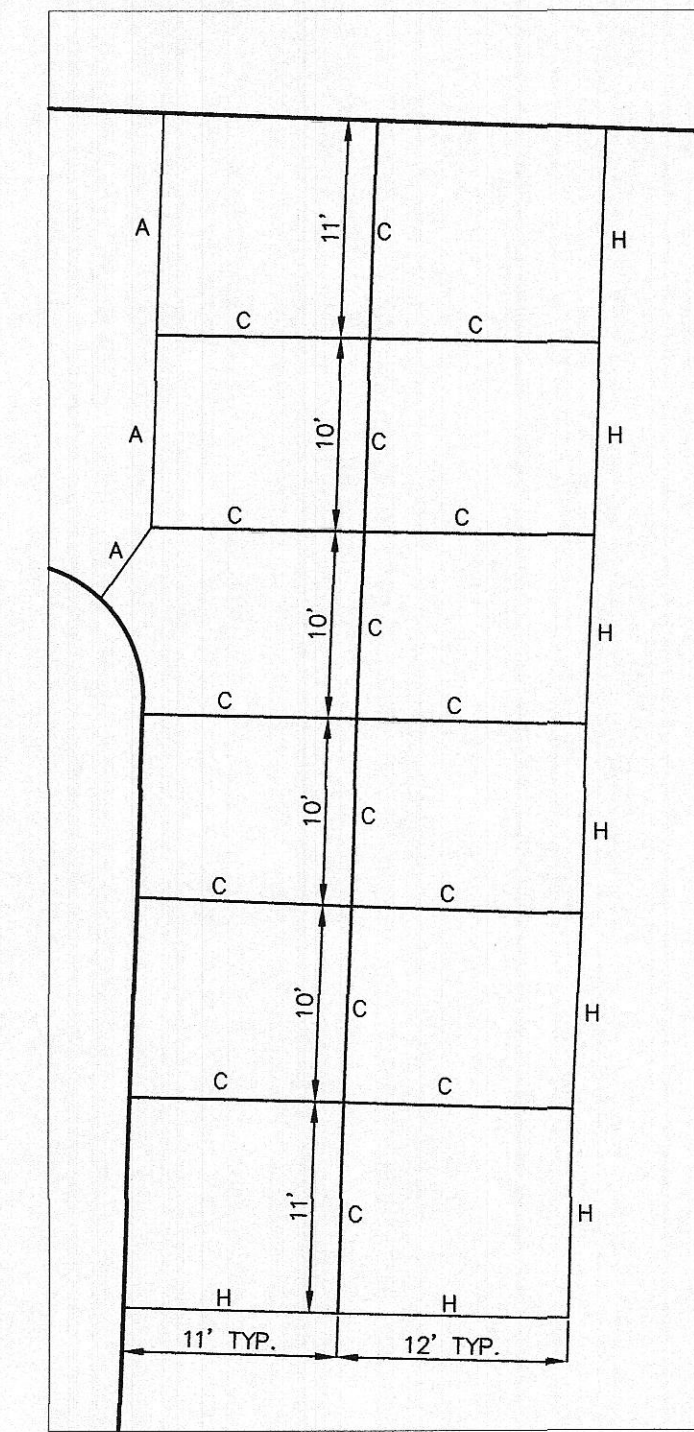

CONCRETE JOINT LAYOUT  
NOTE 4

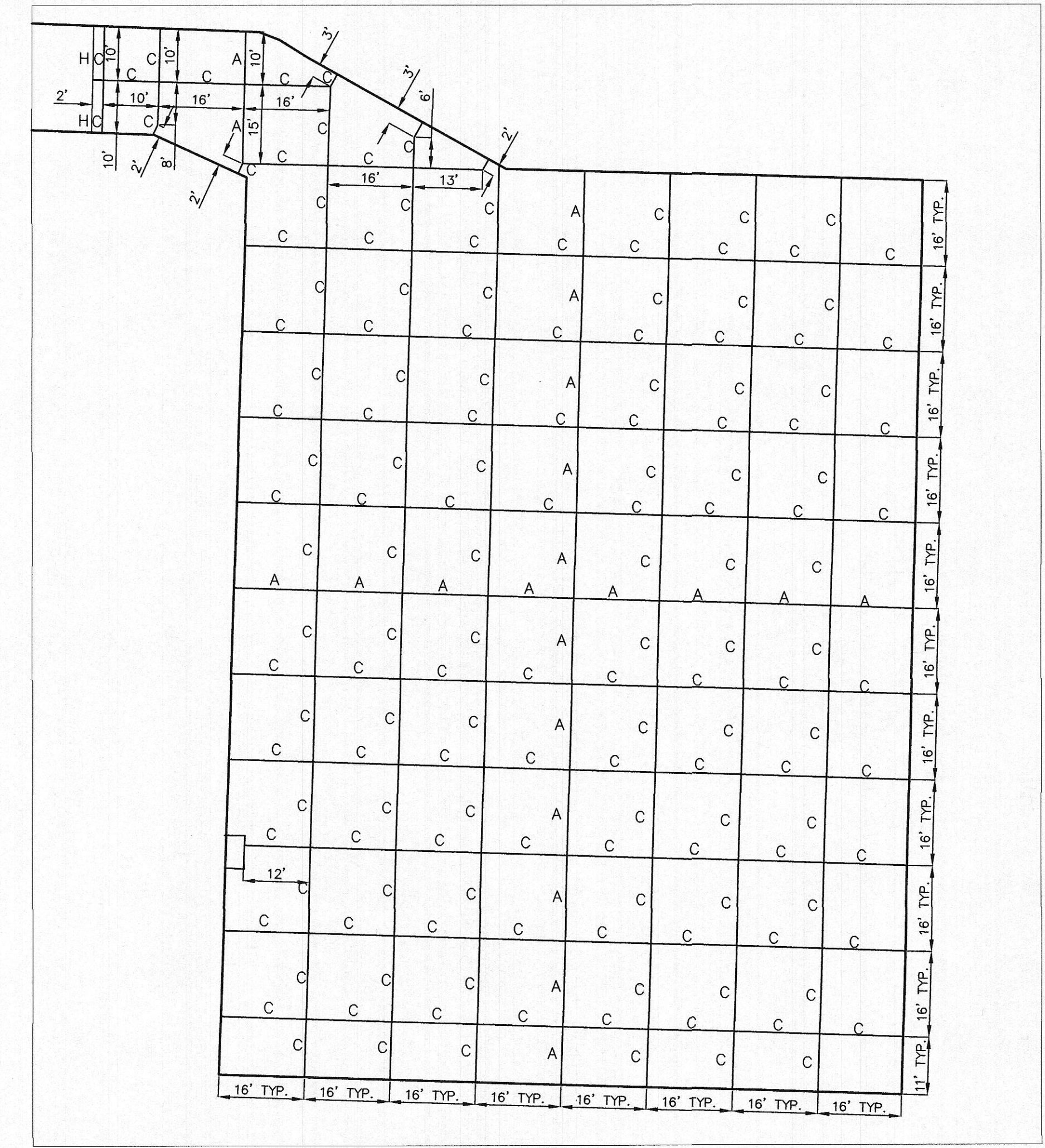

CONCRETE JOINT LAYOUT

**LEGEND:**  
 CONCRETE REPLACEMENT: [Pattern]  
 JOINT: [Line]  
 CRACK REPAIR: [Wavy Line]

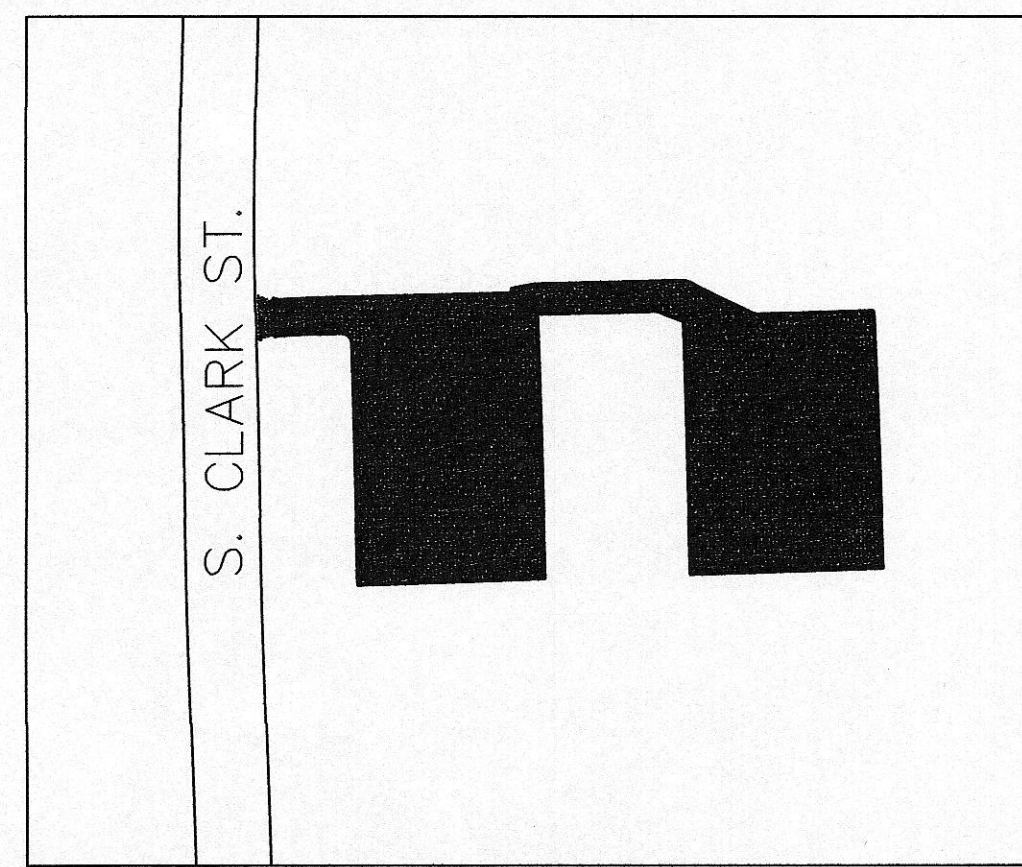

LOCATION MAP

**NOTES:**

1. THE CONTRACTOR SHALL REVIEW SHEET NO. 12 FOR CURB AND GUTTER DETAILS.
2. CONTRACTOR SHALL SAWCUT AND REMOVE EXISTING CONCRETE PAVEMENT AS SHOWN.
3. CONTRACTOR SHALL REVIEW SHEET NO. 12 FOR DETAILS OF CONSTRUCTION ON THIS LOT.
4. CONTRACTOR SHALL USE HIGH EARLY STRENGTH CONCRETE ON THE ENTRANCE POURS. CONTRACTOR SHALL KEEP ONE LANE OPEN AT ALL TIMES. CONTRACTOR SHALL SUBMIT PHASING PLAN TO OWNER REPRESENTATIVE FOR REVIEW.

**NOTES TO THE CONTRACTOR:**

Underground facilities, structures, and utilities have been plotted from available surveys and records and therefore, their locations must be considered approximate only. There may be others, the existence of which is at present not known. Verification of the locations of underground utilities, shown or not shown, will be the responsibility of the construction contractor.  
 The contractor shall make suitable and timely requests to all utility owners, pipeline owners, or other parties affected to have all necessary adjustments of public or private utilities, pipe lines, or other appurtenances within, or adjacent to the limits of construction, as soon as practical or possible.

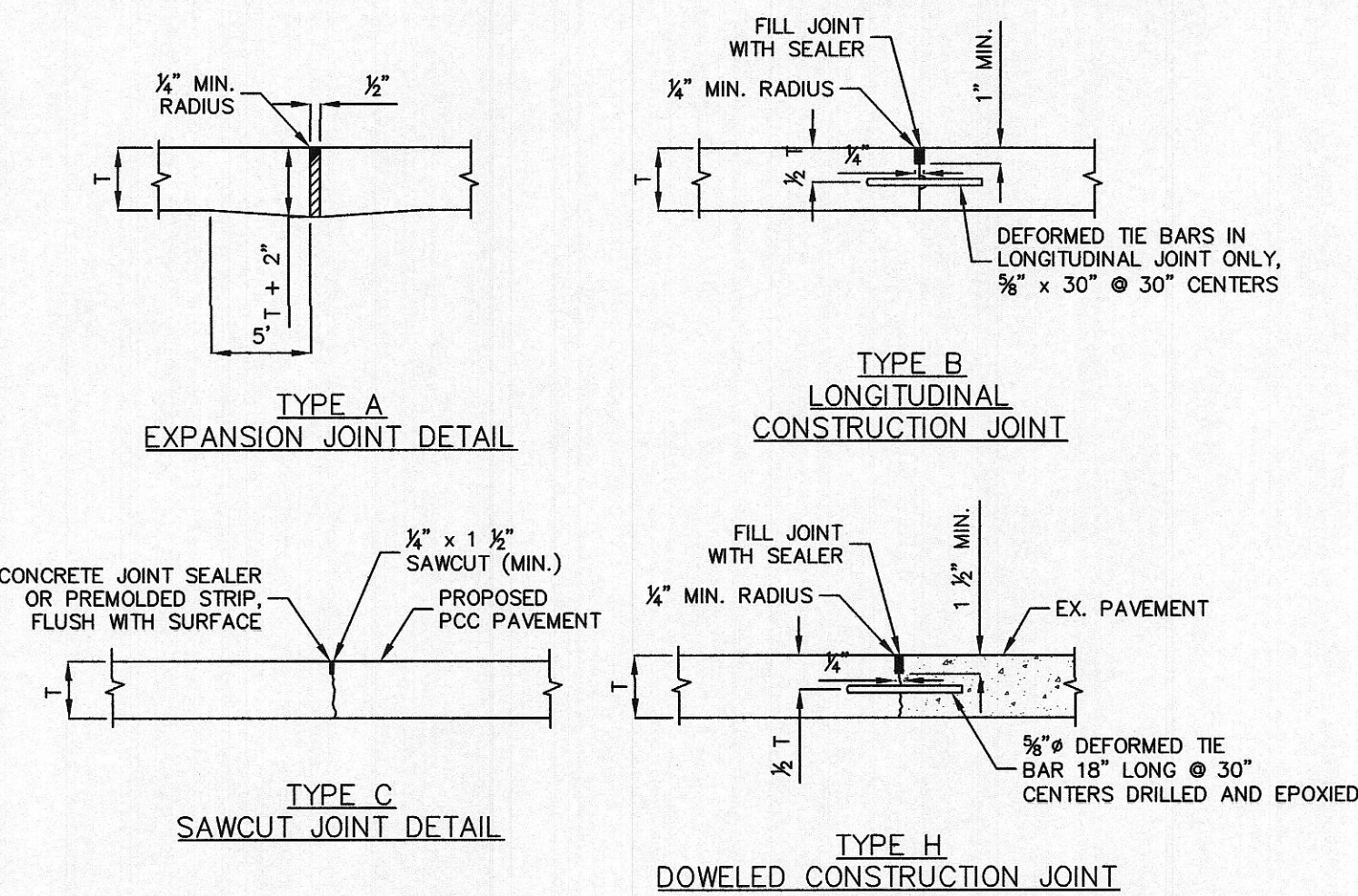

BID SET ISSUED: 03/25/2024

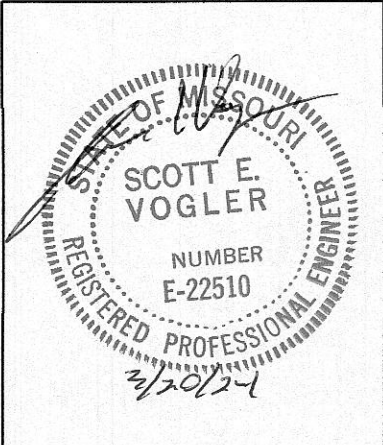

NO.	DATE	REVISION DESCRIPTION	BY

**MECO**  
ENGINEERING CO., INC.  
 mecoengineering.com  
 MO Engineering Lic. #000898 - IL Design Firm #184-001749

**OFFICE LOCATIONS**  
 HANNBAL, MO  
 JEFFERSON CITY, MO  
 BRANSON, MO  
 BOONVILLE, MO  
 PITTSFIELD, IL

THE PROFESSIONAL WHOSE SIGNATURE AND PERSONAL SEAL APPEARS ON THIS SHEET ASSUMES RESPONSIBILITY ONLY FOR WHAT APPEARS ON THIS PAGE, AND DISCLAIMS (PURSUANT TO SECTION 327.411 RSMO) & (PURSUANT TO 225 ILCS 325/PROFESSIONAL ENGINEERING PRACTICE ACT OF 1989) ANY RESPONSIBILITY FOR ALL OTHER PLANS, SPECIFICATIONS, ESTIMATES, REPORTS, OR OTHER DOCUMENTS OR INSTRUMENTS NOT SEALED BY THE UNDERSIGNED PROFESSIONAL RELATING TO OR INTENDED TO BE USED FOR ANY PART, OR PARTS OF THE PROJECT TO WHICH THIS PAGE REFERS.

<b>VARIOUS LOCATIONS</b>						<b>AUDRAIN CLINIC REPAIR PLAN</b>	
<b>FY24 SUMMER PAVING PROJECT - CONCRETE</b>						<b>UNIVERSITY OF MISSOURI PROJECT NO. CP241343</b>	
SURVEYED	DESIGNED	DRAWN	CHECKED	APPROVED	RELEASED	SCALE	DRAWING NAME
	SEV	EW/TN					Audrain Clinic-C
						PROJECT NUMBER	SHEET NO.
						CP241343	9
						473-070	

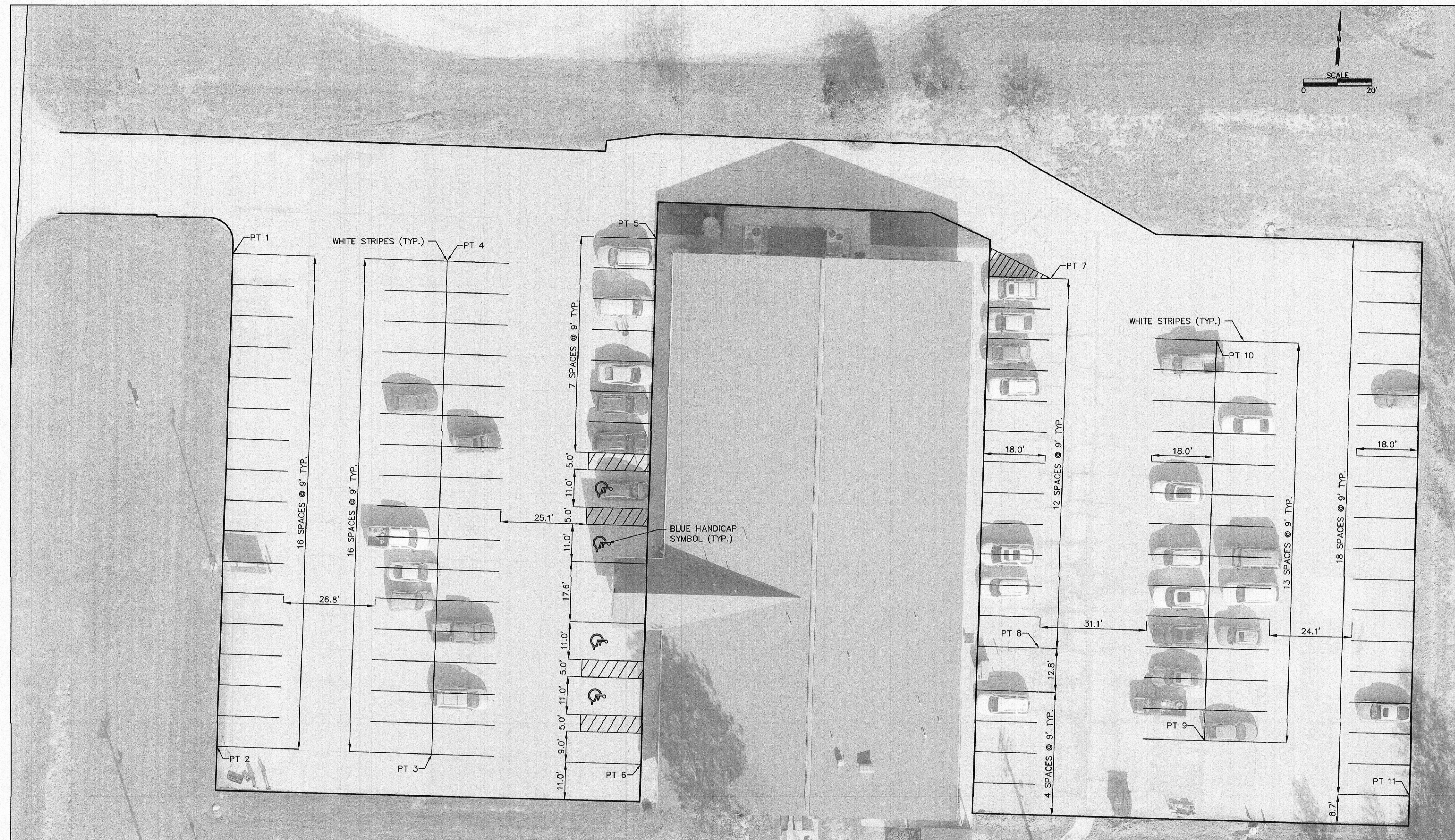

**NOTES:**

- CONTRACTOR SHALL REVIEW SHEET NO. 12 FOR STRIPING DETAILS ON THIS LOT.

Point Table			
Point #	Northing	Easting	Description
1	1303266.5943	1742003.6547	STRIPING
2	1303122.6481	1742007.5896	STRIPING
3	1303124.2282	1742070.4020	STRIPING
4	1303268.1677	1742066.2290	STRIPING
5	1303278.5392	1742126.9232	STRIPING
6	1303125.0487	1742131.5900	STRIPING
7	1303274.0947	1742242.5769	STRIPING
8	1303166.1424	1742245.7863	STRIPING
9	1303142.0153	1742295.6743	STRIPING
10	1303258.9586	1742292.0340	STRIPING
11	1303129.5700	1742356.4709	STRIPING

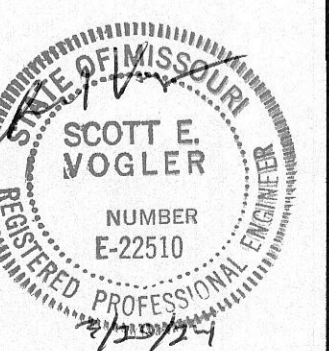

BID SET ISSUED: 03/25/2024

IF THIS DRAWING IS PLOTTED LESS THAN 24x36 IN SIZE, IT IS A REDUCED PLOT - SCALE SHOULD BE ADJUSTED ACCORDINGLY.	NO.	DATE	REVISION DESCRIPTION	BY	 <b>MECO</b> ENGINEERING CO., INC.	OFFICE LOCATIONS HANNBAL, MO JEFFERSON CITY, MO BRANSON, MO BOONVILLE, MO PITTSFIELD, IL	THE PROFESSIONAL WHOSE SIGNATURE AND PERSONAL SEAL APPEARS ON THIS SHEET ASSUMES RESPONSIBILITY ONLY FOR WHAT APPEARS ON THIS PAGE, AND DISCLAIMS (PURSUANT TO SECTION 327.411 RSMO) & (PURSUANT TO 225 ILCS 325/PROFESSIONAL ENGINEERING PRACTICE ACT OF 1989) ANY RESPONSIBILITY FOR ALL OTHER PLANS, SPECIFICATIONS, ESTIMATES, REPORTS, OR OTHER DOCUMENTS OR INSTRUMENTS NOT SEALED BY THE UNDERSIGNED PROFESSIONAL RELATING TO OR INTENDED TO BE USED FOR ANY PART, OR PARTS OF THE PROJECT TO WHICH THIS PAGE REFERS.	<b>VARIOUS LOCATIONS</b> <b>FY24 SUMMER PAVING PROJECT - CONCRETE</b> <b>UNIVERSITY OF MISSOURI PROJECT NO. CP241343</b>					<b>AUDRAIN CLINIC STRIPING PLAN</b>		
									SURVEYED SEV	DRAWN EW/TN	CHECKED	APPROVED	RELEASED	SCALE	DRAWING NAME Audrain Clinic-C

L:\03\Projects\CP241343\MO\_2024\Summer Paving - Design\DRAWINGS\CONCRETE PAVING\AUDRAIN CLINIC-C.dwg, STRIPES, 3/18/2024 7:58:10 AM

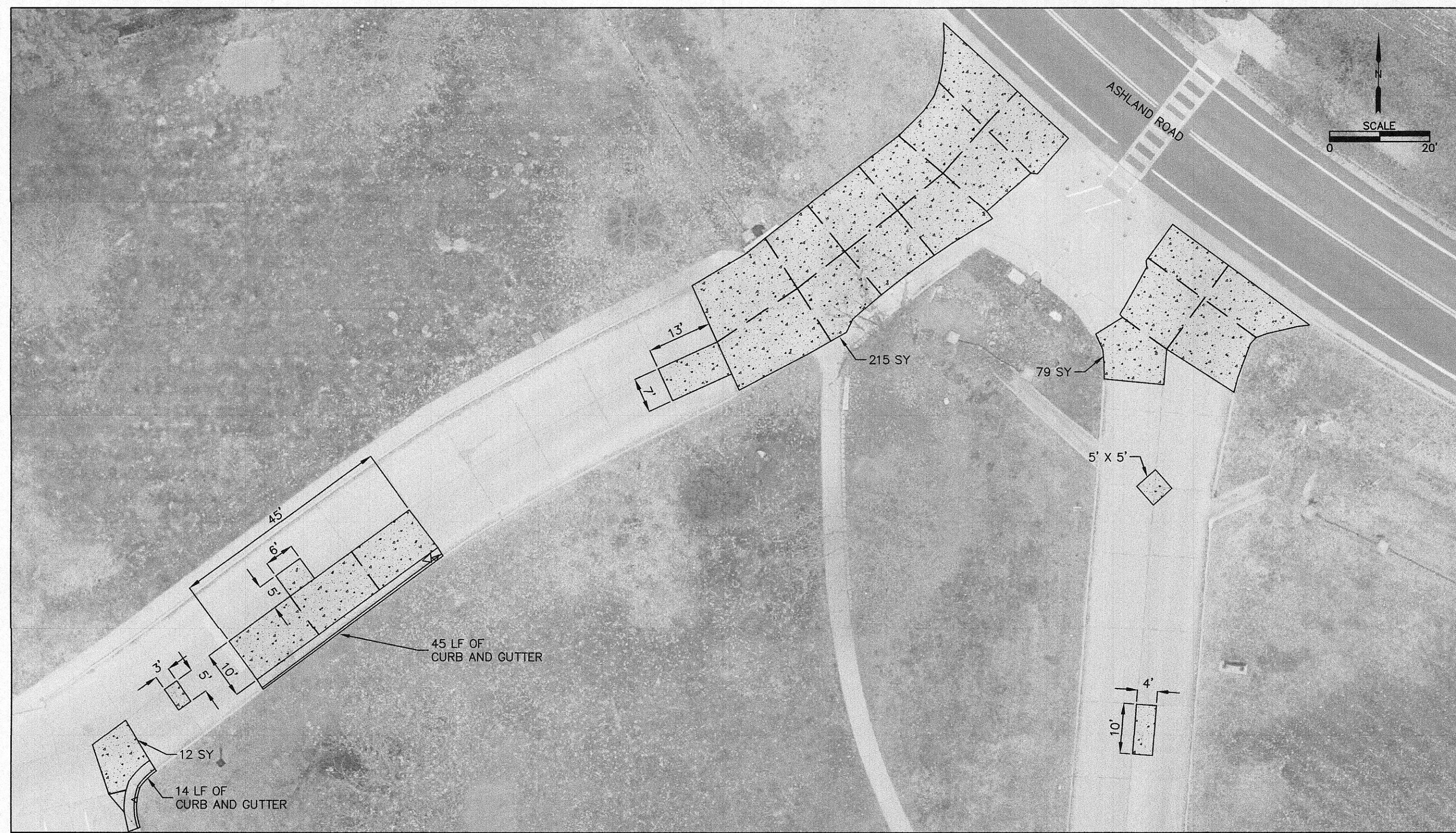

REPAIR PLAN

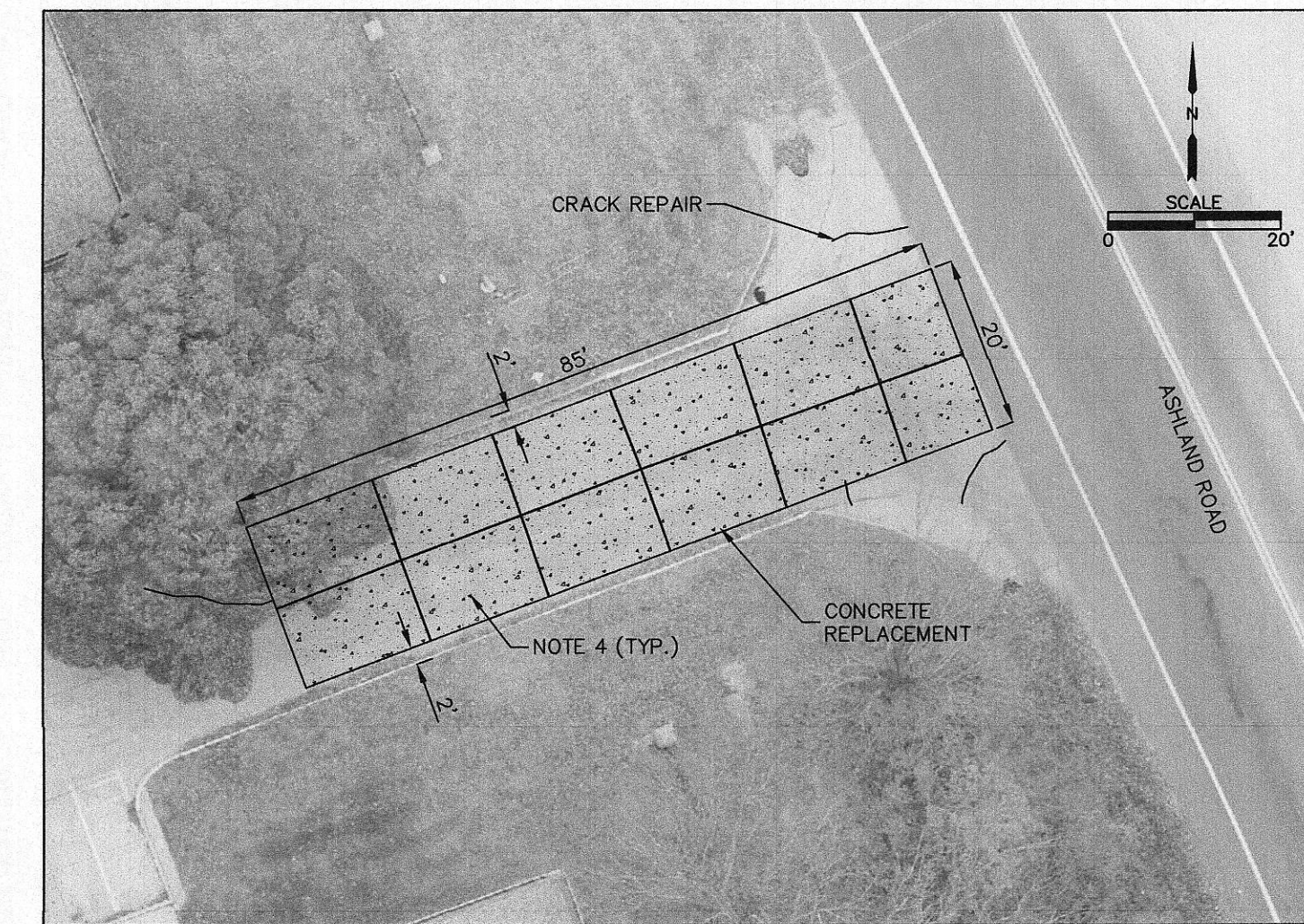

REPAIR PLAN

LEGEND:

- CONCRETE REPLACEMENT:
- JOINT:
- CRACK REPAIR:

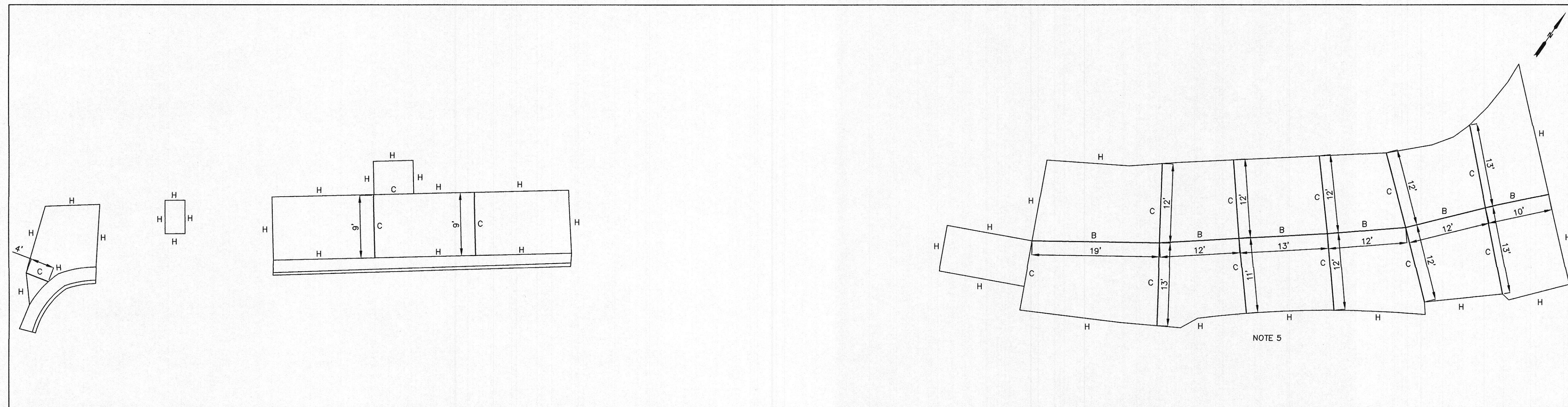

CONCRETE JOINT LAYOUT

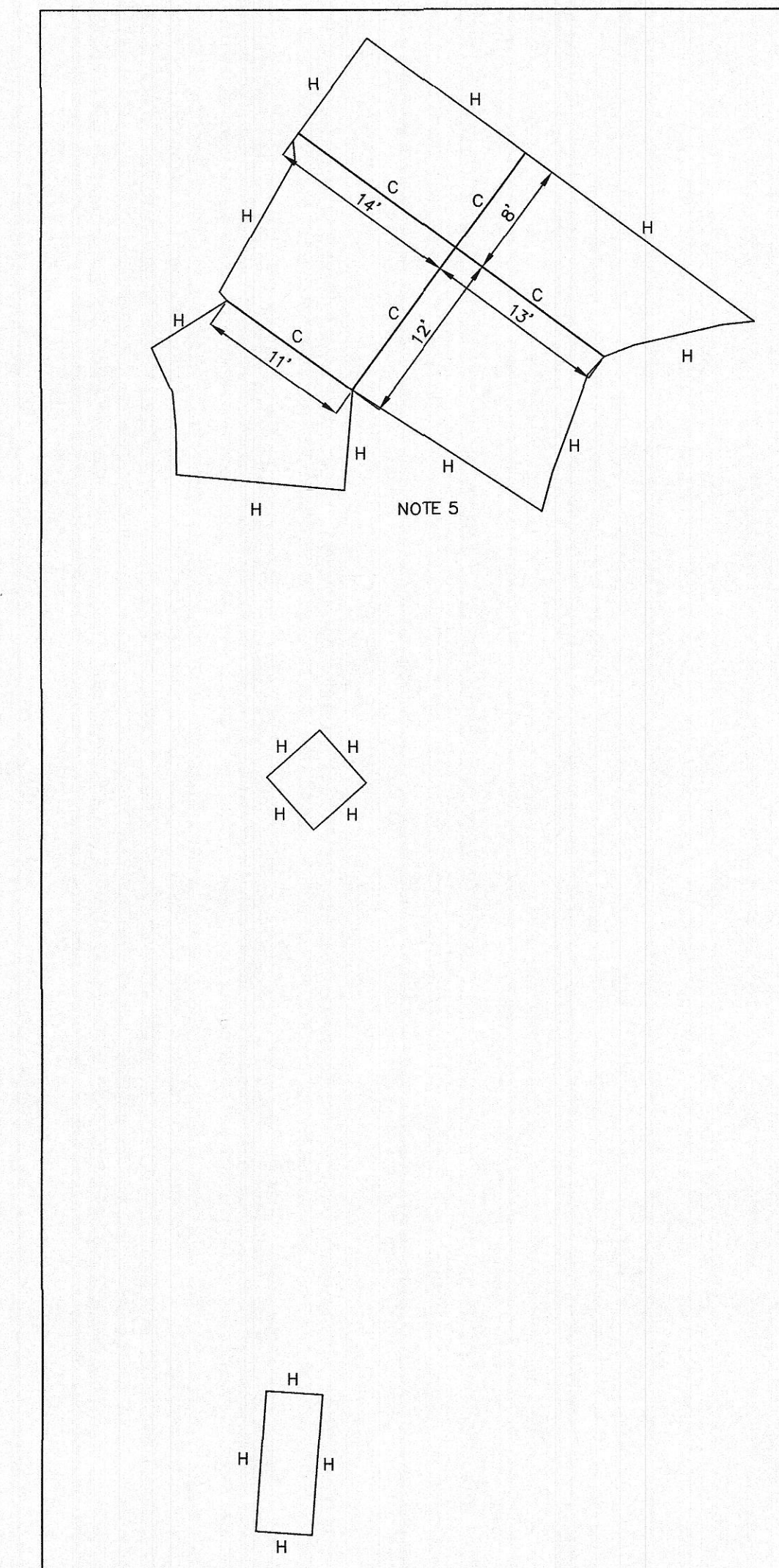

CONCRETE JOINT LAYOUT

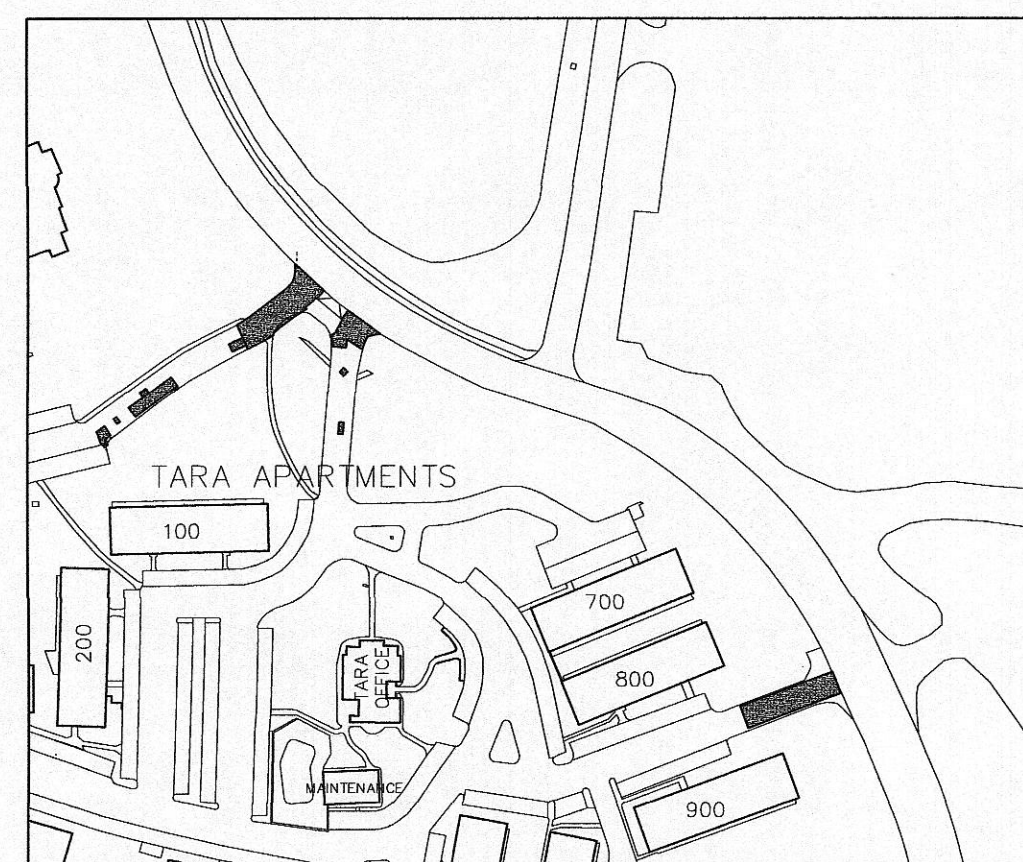

LOCATION MAP

NOTES:

1. THE CONTRACTOR SHALL CLEAN AND FILL ANY CRACK THAT MEASURES  $\frac{1}{8}$ " WIDE OR MORE. ALL CRACKS SHOWN ARE REPRESENTATIVE OF THE CRACKS TO BE FILLED AND NO EXTRA PAYMENT SHALL BE GIVEN FOR ANY CRACK NOT SHOWN. THE CONTRACTOR SHALL ASCERTAIN THE LOCATION, SIZE, AND AMOUNT OF CRACKS TO BE FILLED.
2. CONTRACTOR SHALL SAWCUT AND REMOVE EXISTING CONCRETE PAVEMENT AS SHOWN.
3. CONTRACTOR SHALL REVIEW SHEET NO. 12 FOR DETAILS OF CONSTRUCTION ON THIS DRIVE.
4. CONTRACTOR SHALL SAWCUT CONCRETE 2 FEET FROM BACK OF CURB TO CREATE A GUTTER.
5. CONTRACTOR SHALL USE HIGH EARLY STRENGTH CONCRETE ON THE ENTRANCE POURS. CONTRACTOR SHALL KEEP ONE LANE OPEN AT ALL TIMES. CONTRACTOR SHALL SUBMIT PHASING PLAN TO OWNER REPRESENTATIVE FOR REVIEW.

NOTES TO THE CONTRACTOR:

Underground facilities, structures, and utilities have been plotted from available surveys and records and therefore, their locations must be considered approximate only. There may be others, the existence of which is at present not known. Verification of the locations of underground utilities, shown or not shown, will be the responsibility of the construction contractor.  
The contractor shall make suitable and timely requests to all utility owners, pipeline owners, or other parties affected to have all necessary adjustments of public or private utilities, pipe lines, or other appurtenances within, or adjacent to the limits of construction, as soon as practical or possible.

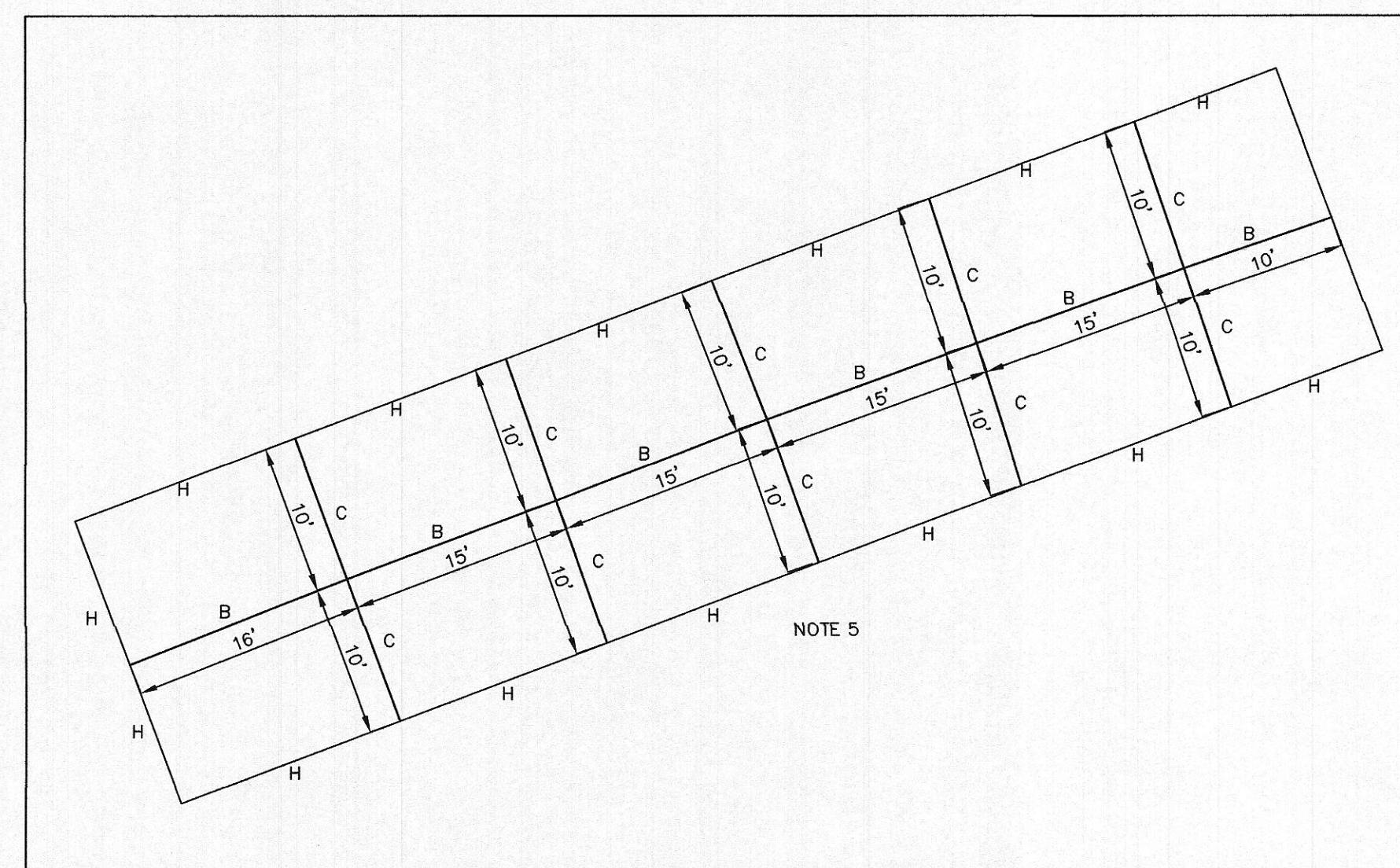

CONCRETE JOINT LAYOUT

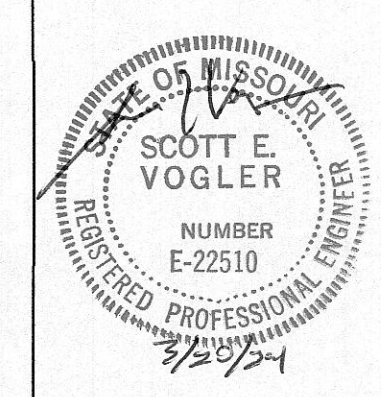

BID SET ISSUED: 03/25/2024

NO.	DATE	REVISION DESCRIPTION	BY

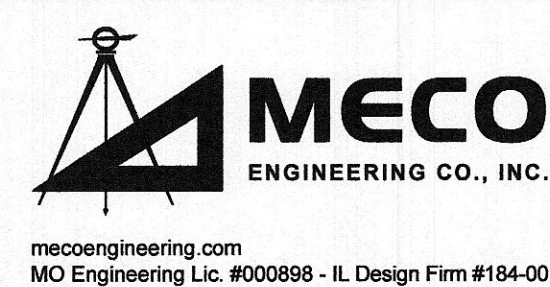

OFFICE LOCATIONS  
HANNIBAL, MO  
JEFFERSON CITY, MO  
BRANSON, MO  
BOONVILLE, MO  
PITTSFIELD, IL

THE PROFESSIONAL WHOSE SIGNATURE AND PERSONAL SEAL APPEARS ON THIS SHEET ASSUMES RESPONSIBILITY ONLY FOR WHAT APPEARS ON THIS PAGE, AND DISCLAIMS (PURSUANT TO SECTION 327.411 RSMO) & (PURSUANT TO 225 ILCS 325/PROFESSIONAL ENGINEERING PRACTICE ACT OF 1989) ANY RESPONSIBILITY FOR ALL OTHER PLANS, SPECIFICATIONS, ESTIMATES, REPORTS, OR OTHER DOCUMENTS OR INSTRUMENTS NOT SEALED BY THE UNDERSIGNED PROFESSIONAL RELATING TO OR INTENDED TO BE USED FOR ANY PART, OR PARTS OF THE PROJECT TO WHICH THIS PAGE REFERS.

VARIOUS LOCATIONS					
FY24 SUMMER PAVING PROJECT - CONCRETE					
UNIVERSITY OF MISSOURI PROJECT NO. CP241343					
SURVEYED	DESIGNED	DRAWN	CHECKED	APPROVED	RELEASED
	SEV	EW/TN			

TARA APARTMENTS REPAIR PLAN			
SCALE	DRAWING NAME	PROJECT NUMBER	SHEET NO.
	TARA Design-C	CP241343 473-070	11

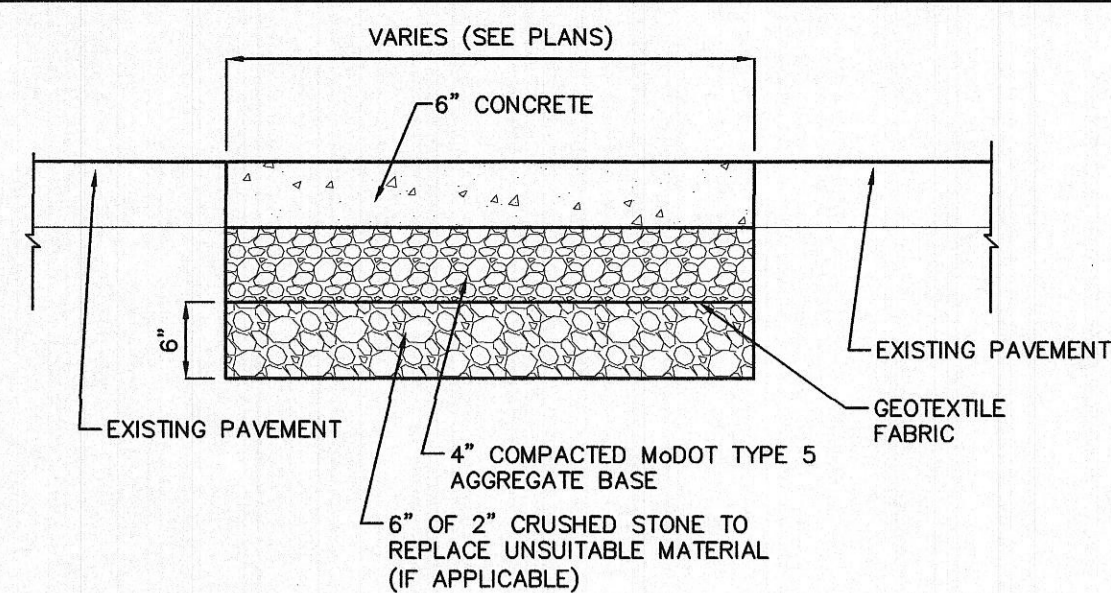

**6" PCC CONCRETE REPLACEMENT**  
(TARA APARTMENTS, AUDRAIN CLINIC)

NOT TO SCALE

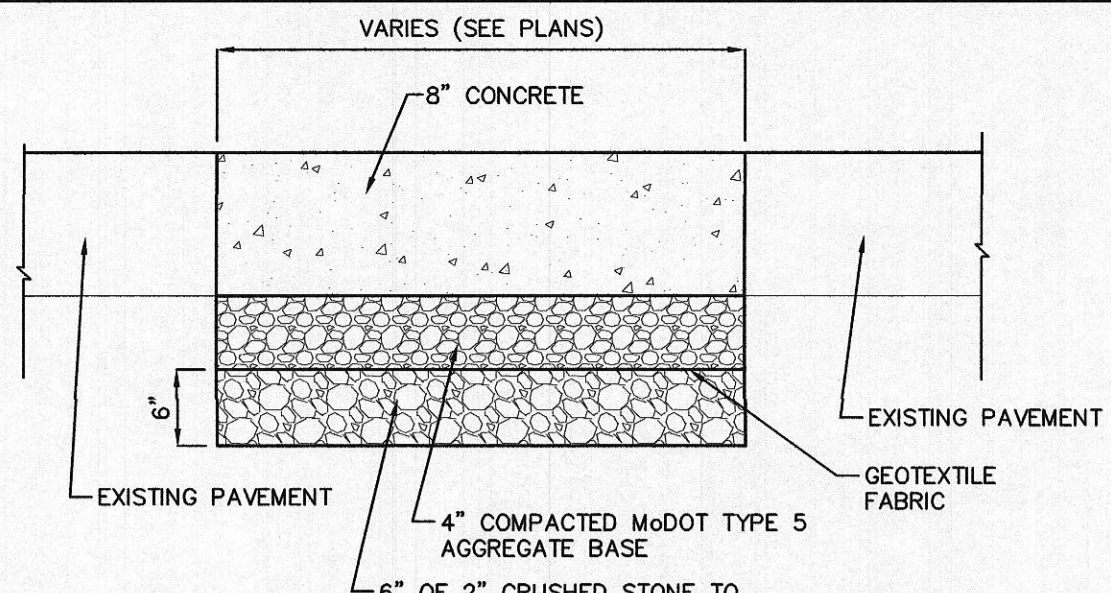

**8" PCC CONCRETE REPLACEMENT**  
(MICK DEAVER)

NOT TO SCALE

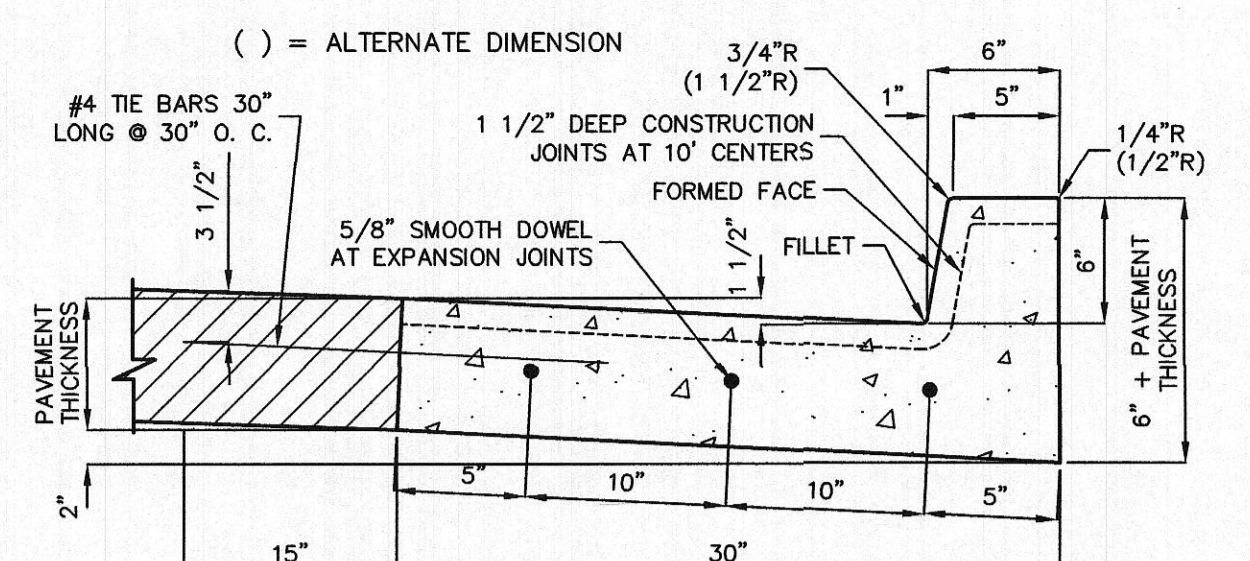

**30" TYPE "A" CURB AND GUTTER**  
(CONCRETE STREET)

NOTES:

- EXPANSION JOINTS SHALL BE INSTALLED AT CURB RETURN RADIUS POINTS, INLET RETURNS, AND AT DRIVE APPROACHES. 1/2" EXPANSION MATERIAL WITH 5/8" x 24" SMOOTH DOWELS SHALL BE USED. THESE DOWELS SHALL BE GREASED AND WRAPPED ON ONE END WITH EXPANSION TUBES.
- THE EXPANSION JOINT MATERIAL SHALL BE GRAY SPONGE RUBBER FULL DEPTH.
- CONSTRUCTION JOINTS MAY BE SAWED, OR PRE-FORMED.
- ALL JOINTS SHALL BE CUT AT 10' ON CENTER. ALL JOINTS SHALL BE FILLED WITH JOINT SEALER.
- CONTRACTOR SHALL PLACE 4" OF COMPACTED M&DOT TYPE 5 AGGREGATE BASE UNDER ALL CURB AND GUTTER.

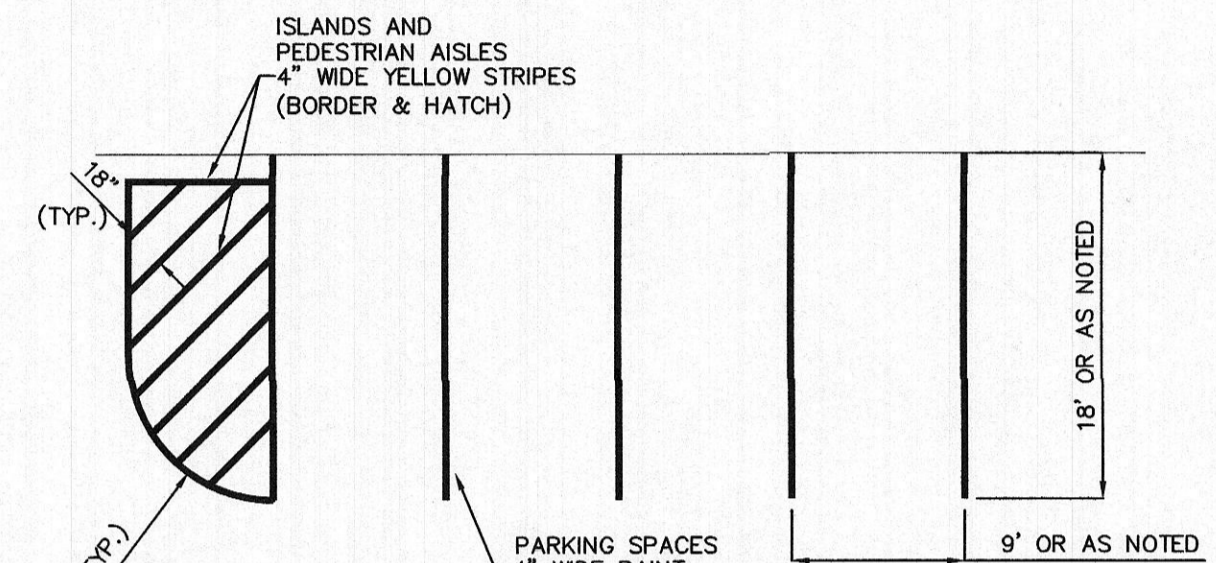

**STANDARD SPACES**

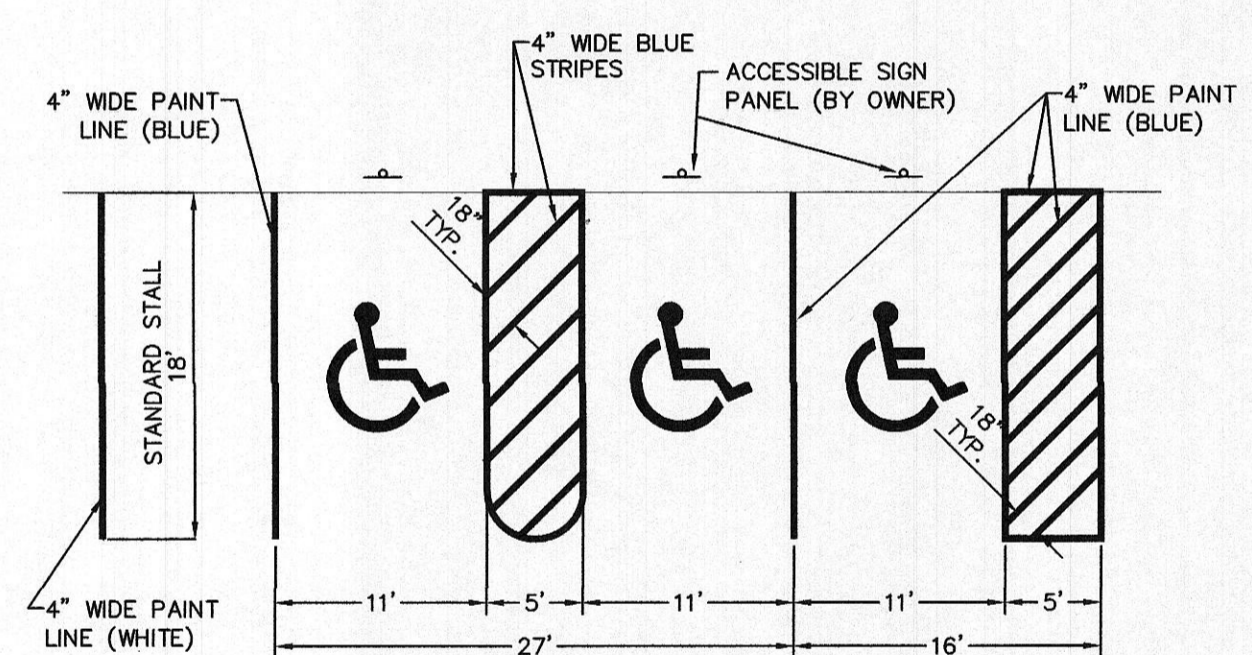

**UNIVERSAL ACCESSIBLE SPACES**

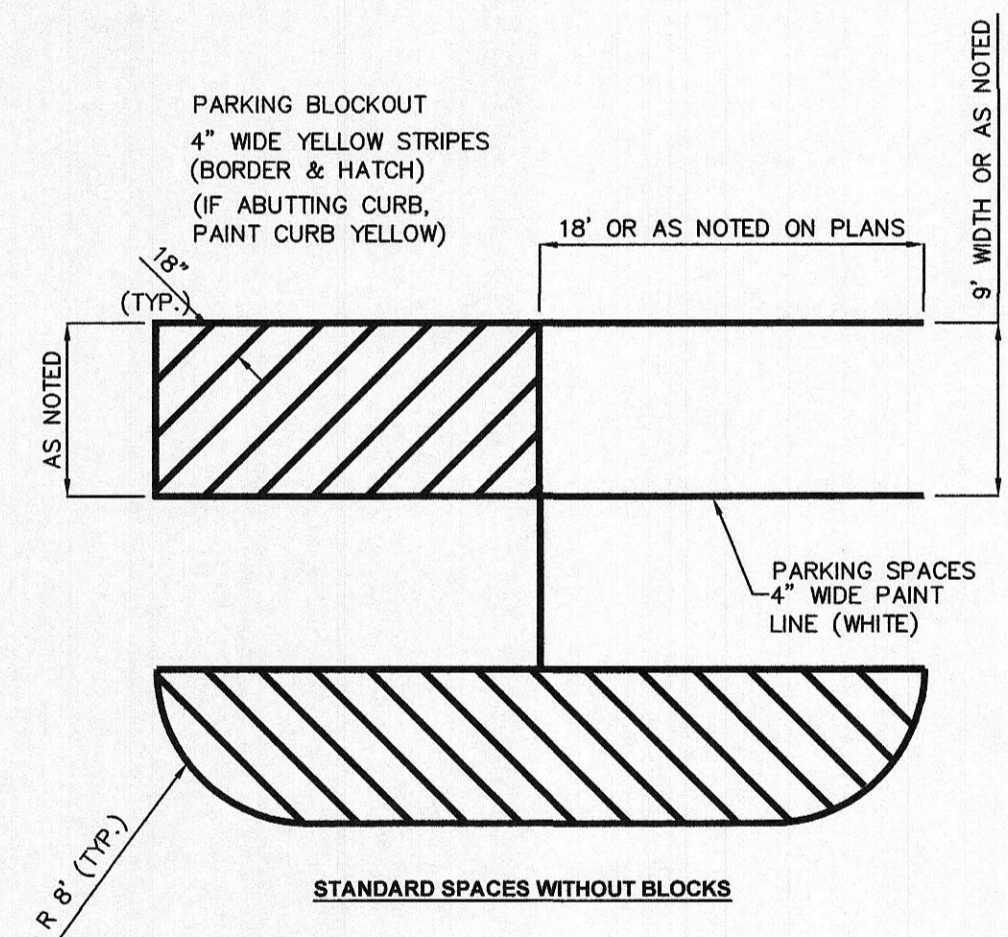

**STANDARD SPACES WITHOUT BLOCKS**

**TYPICAL PAVEMENT MARKING**

NOT TO SCALE

IF THIS DRAWING IS PLOTTED LESS THAN 24x36 IN SIZE, IT IS A REDUCED PLOT - SCALE SHOULD BE ADJUSTED ACCORDINGLY

NO.	DATE	REVISION DESCRIPTION	BY

**MECO ENGINEERING CO., INC.**  
 HANIBAL, MO  
 JEFFERSON CITY, MO  
 BRANSON, MO  
 BOONVILLE, MO  
 PITTSFIELD, IL

THE PROFESSIONAL WHOSE SIGNATURE AND PERSONAL SEAL APPEARS ON THIS SHEET ASSUMES RESPONSIBILITY ONLY FOR WHAT APPEARS ON THIS PAGE, AND DISCLAIMS (PURSUANT TO SECTION 327.411 RSMO) & (PURSUANT TO 225 ILCS 325/PROFESSIONAL ENGINEERING PRACTICE ACT OF 1989) ANY RESPONSIBILITY FOR ALL OTHER PLANS, SPECIFICATIONS, ESTIMATES, REPORTS, OR OTHER DOCUMENTS OR INSTRUMENTS NOT SEALED BY THE UNDERSIGNED PROFESSIONAL RELATING TO OR INTENDED TO BE USED FOR ANY PART, OR PARTS OF THE PROJECT TO WHICH THIS PAGE REFERS.

**VARIOUS LOCATIONS**  
**FY24 SUMMER PAVING PROJECT - CONCRETE**  
**UNIVERSITY OF MISSOURI PROJECT NO. CP241343**

SURVEYED	DESIGNED	DRAWN	CHECKED	APPROVED	RELEASED
	SEV	EW/TN			

**TYPICAL SECTIONS AND DETAILS**

SCALE	DRAWING NAME	PROJECT NUMBER	SHEET NO.
NOT TO SCALE	C-501-C	CP241343 473-070	12

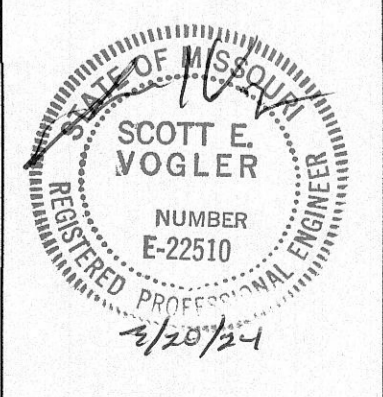

**BID SET ISSUED: 03/25/2024**

L:\2024\Projects\FY24\MOU\CP241343\Summer Paving - Design\DRAWINGS\CONCRETE\PACKAGED\CP-C-4a.dwg, Typical Details, 3/19/2024 7:28:28 AM